

13



ACCOUNTS
DEPARTMENT

SUZUKI **V100**
Scooter

PARTS CATALOGUE

1992

FIG. 1

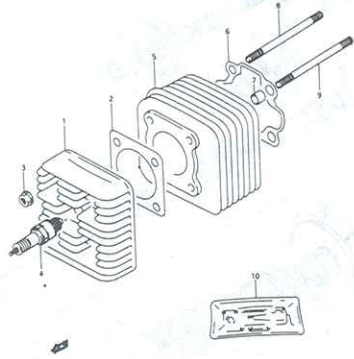

FIG. 2

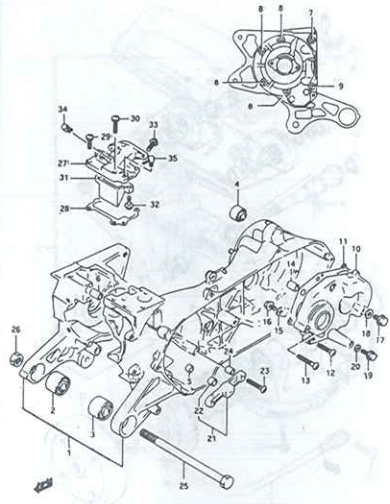

FIG. 3

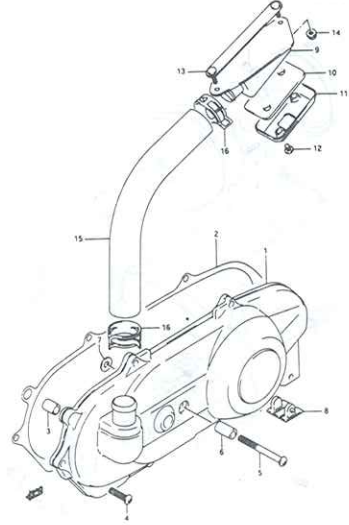

FIG. 4

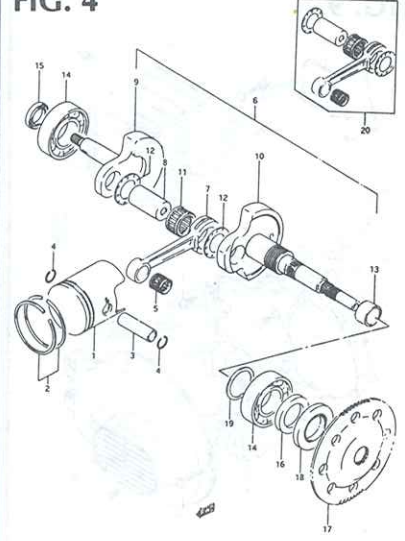

FIG. 5

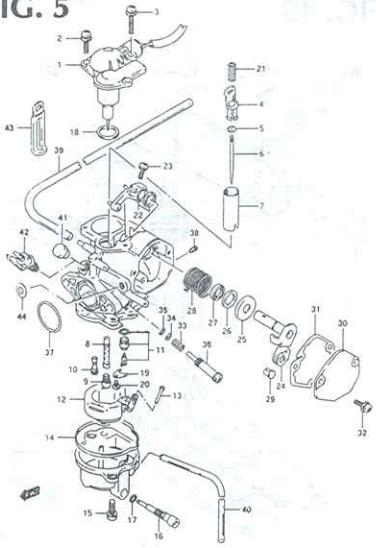

FIG. 6

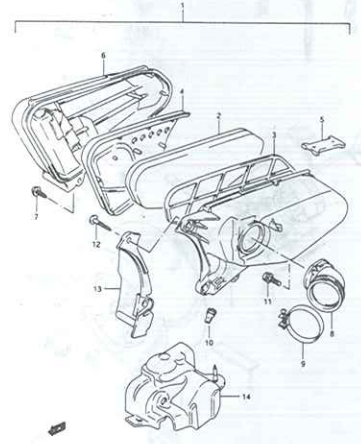

FIG. 7

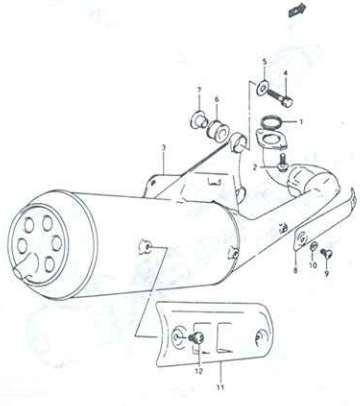
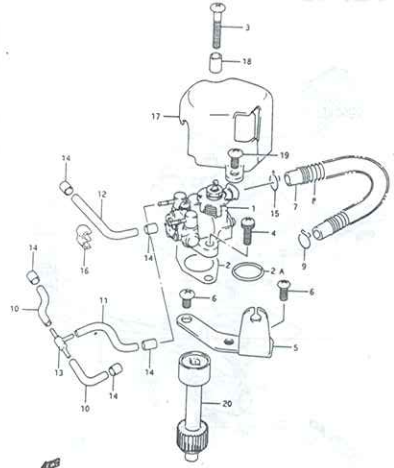

FIG. 8



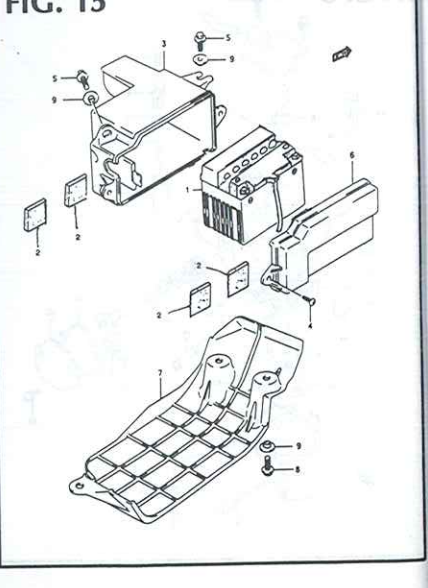
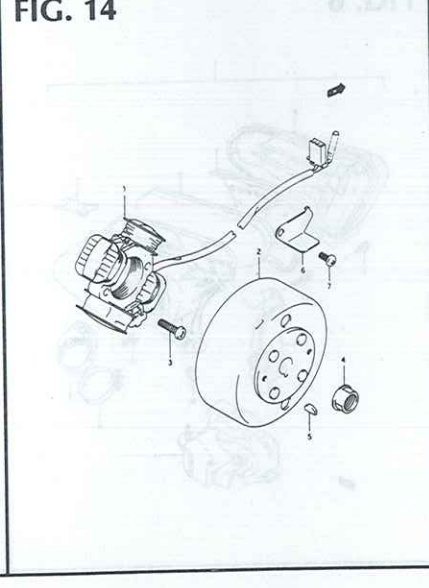
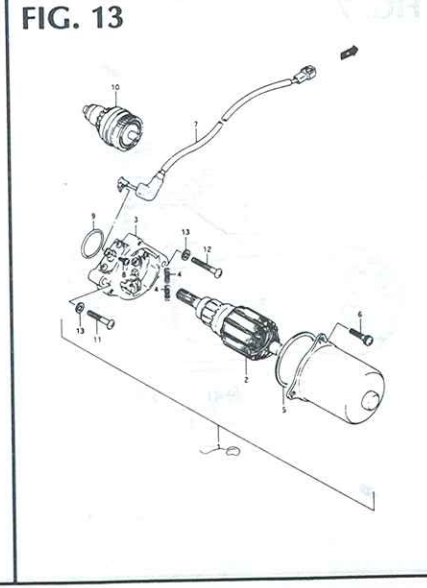
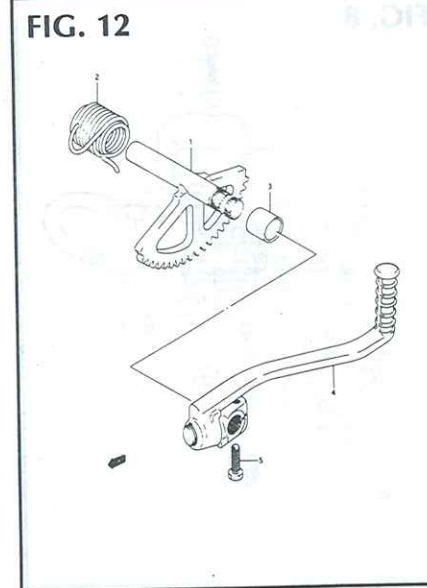
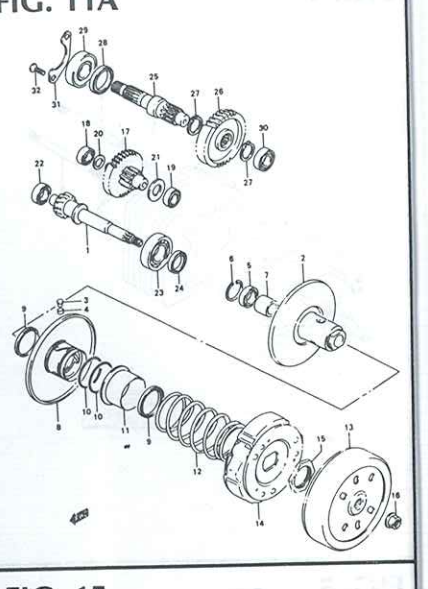
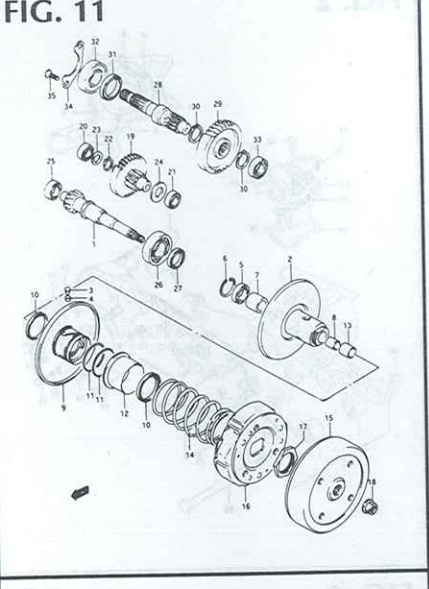
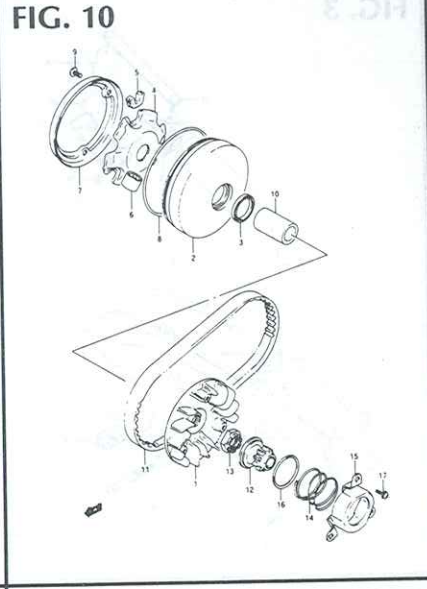
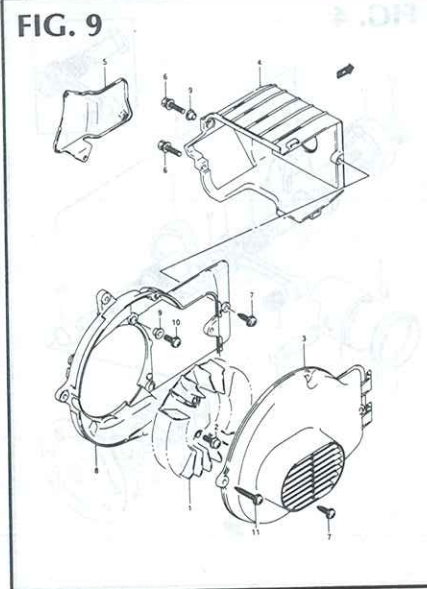

FIG. 24

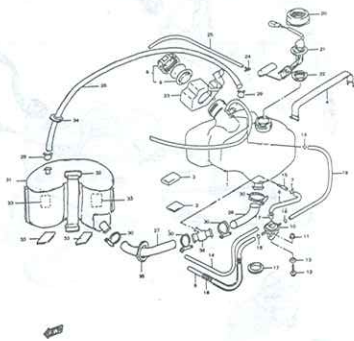

FIG. 25

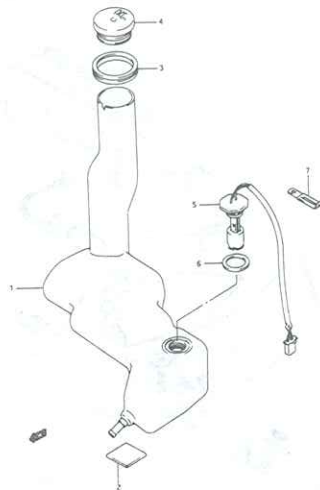

FIG. 26

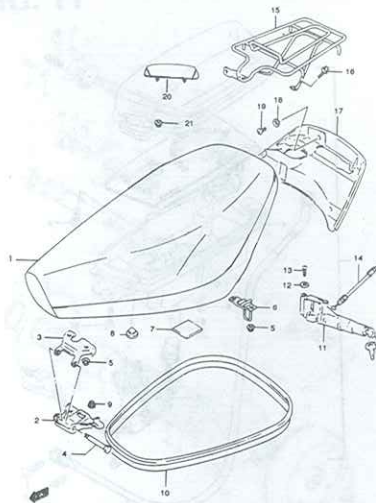

FIG. 27

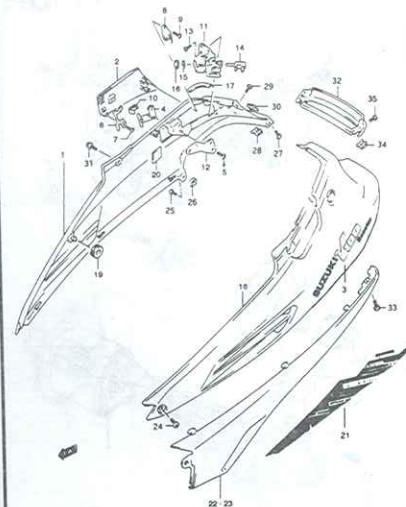

FIG. 28

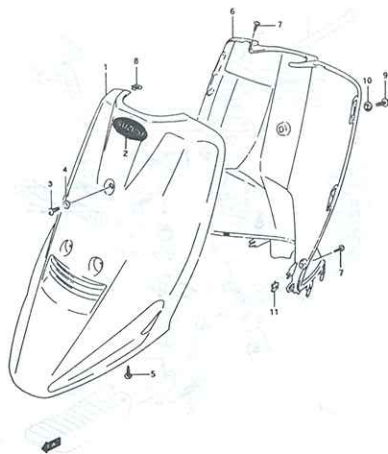

FIG. 29

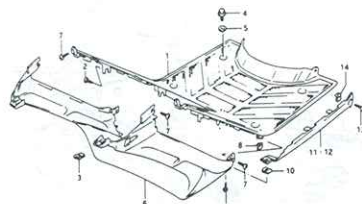

FIG. 30

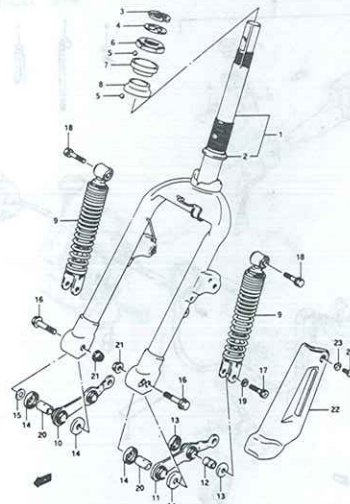

FIG. 31

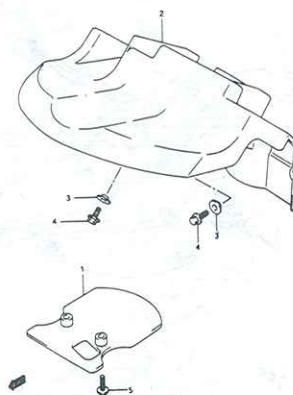

FIG. 32

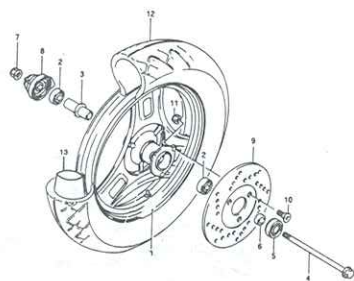

FIG. 33

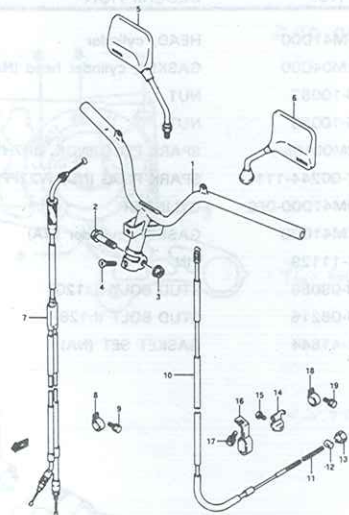

FIG. 34

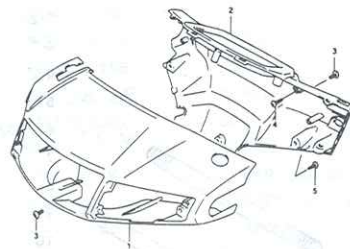

FIG. 35

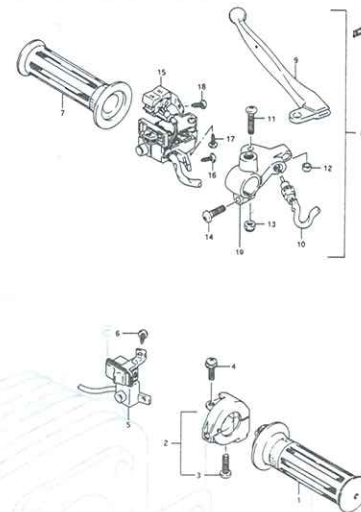

FIG. 36

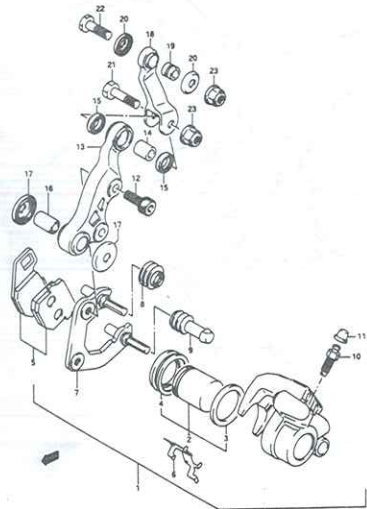

FIG. 37

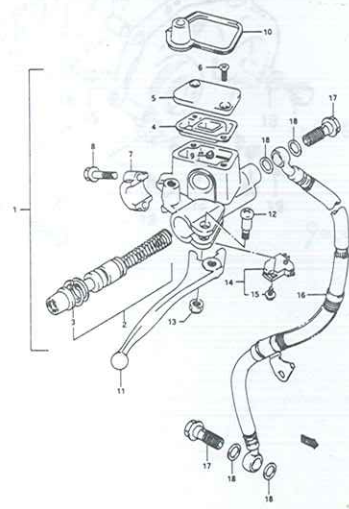

FIG. 38

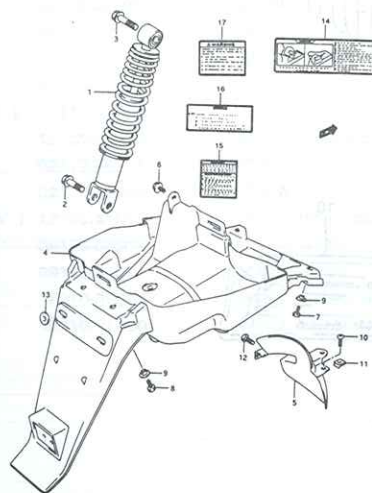
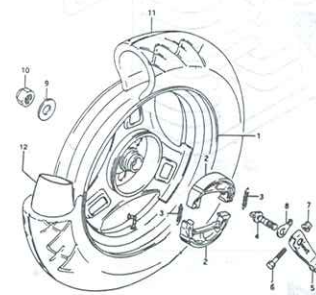
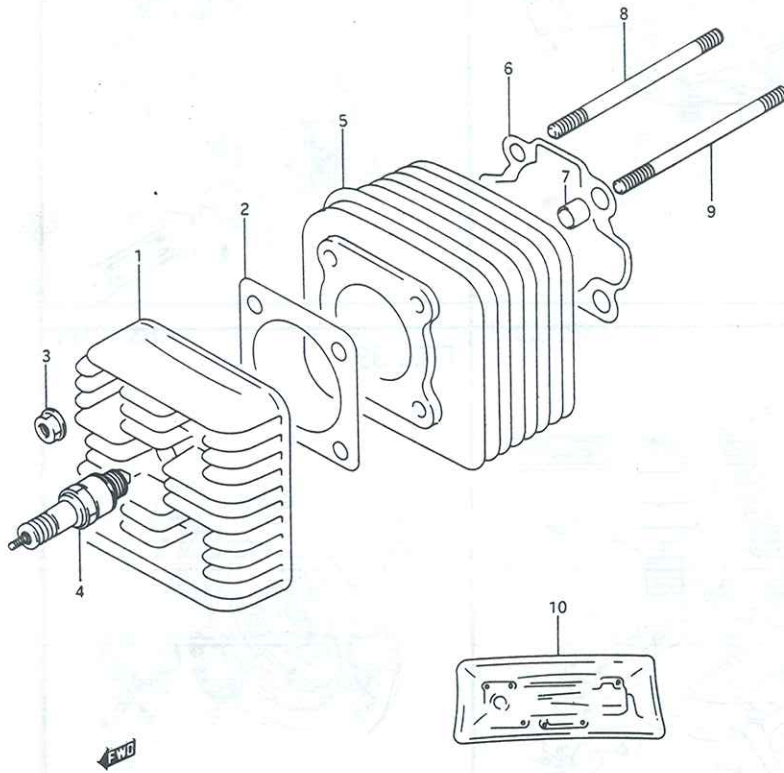

FIG. 39



2

FIG. 1



V100

FIG. 1 (B-2) CYLINDER

REF. NO.	PART NO.	DESCRIPTION	Q'TY	REMARKS
1	11111M41D00	HEAD, cylinder	1	
2	11141M04C00	GASKET, cylinder head (NA)	1	
3-1	08316-10087	NUT	4	
3-2	08316-10083	NUT	4	
4-1	09482M00105268	SPARK PLUG (NGK, BP7HS)	1	
4-2	09482-00244-111	SPARK PLUG (ND, W22FPR)	1	
5	11210M41D00-0F0	CYLINDER	1	
6	11241M41D20	GASKET, cylinder (NA)	1	
7	04211-11129	PIN	2	
8	09108-08056	STUD BOLT (L:120)	2	
9	09108-08216	STUD BOLT (L:126)	2	
10	11401-41844	GASKET SET (NA)	1	

FIG. 2

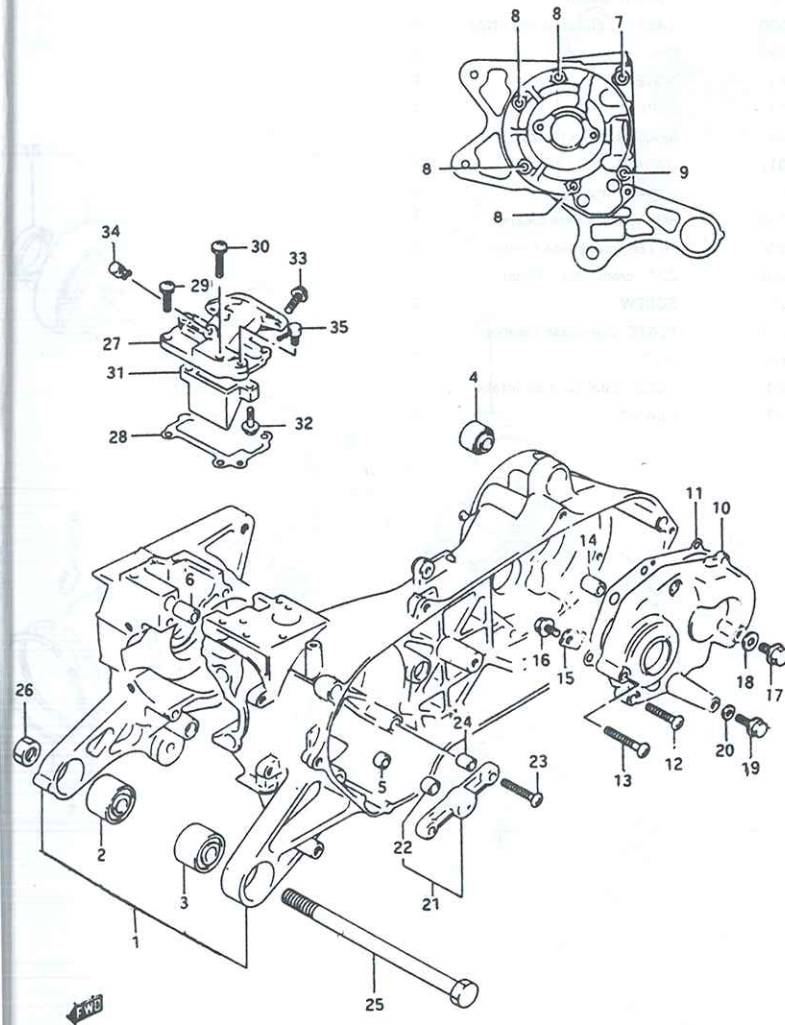

V100

FIG. 2 (B-3) CRANKCASE

REF. NO.	PART NO.	DESCRIPTION	Q'TY	REMARKS
1	11310M41D00	CRANKCASE SET	1	
2	09319-12051	.BUSH	1	
3	09319-12051	.BUSH	1	
4	09319-10032	.BUSH	1	
5	09300-08016	.BUSH	1	
6	04211-11169	PIN	2	
7	02112-06753	SCREW	1	
8	02112-06507	SCREW	4	
9	02112-06857	SCREW	1	
10	11431-41D00	COVER, gear box	1	
11	11484-41D00	GASKET, gear box cover (NA)	1	
12	02112-06257	SCREW	5	
13	02112-06357	SCREW	1	
14	04211-11169	PIN	2	
15	11393-20E00	MAGNET, gear box	1	
16	01550-06127	BOLT	1	
17	01550-08127	BOLT, oil level	1	
18	09168-08008	GASKET	1	
19	01550-06127	BOLT, oil drain	1	
20	09168-06004	GASKET	1	
21	11380-37811	CAP SET, starter idle gear	1	
22	09300-08016	.BUSH	1	
23	02112-06307	SCREW	2	
24	04211-09109	PIN	2	
25	09100-12028	BOLT (12x185)	1	
26	08310-00127	NUT	1	
27	13111-41D02	PIPE, intake	1	
28	13125M41D00	GASKET, intake pipe (NA)	1	
29	02112-36203	SCREW	3	
30	02112-36253	SCREW	1	
31	13150-41D10	VALVE ASSY, reed	1	
32	09138-04005	SCREW (4x20)	2	
33	09128-06071	SCREW (6x19)	2	
34	16910-09C00	CHECK VALVE, oil hose	1	
35	16910-21D00	NIPPLE, oil hose No. 2	2	

2

FIG. 3

FIG. 3 (B-4)CRNKCASE LH COVER

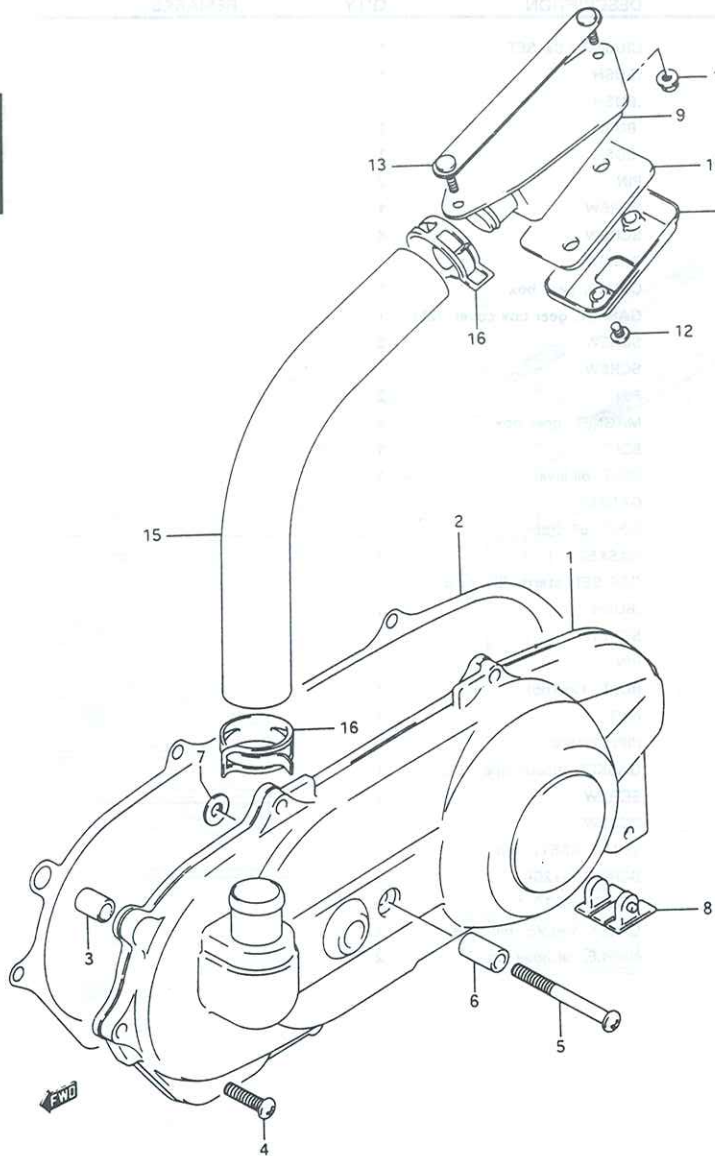

V100

REF. NO.	PART NO.	DESCRIPTION	Q'TY	REMARKS
1	11340-41810	COVER, clutch	1	
2	11482M41D00	GASKET, clutch cover (NA)	1	
3	04211-11169	PIN	2	
4	02112-06253	SCREW	6	
5	02112-06653	SCREW	1	
6	09180-06242	SPACER (6.2x12x22)	1	
7	09168-07001	GASKET	1	
8	11327-41D00	COVER, mud guard	1	
9	17170M41D10	BODY, crankcase cleaner	1	
10	17174-41D00	FILTER, crankcase cleaner	1	
11	17181M41D00	CAP, crankcase cleaner	1	
12	02112-06125	SCREW	2	
13	17190M41D00	PLATE, crankcase cleaner	1	
14	08319-31065	NUT	2	
15	17175-41D01	HOSE, crankcase air intake	1	
16	09401-31403	CLAMP	2	

FIG. 4

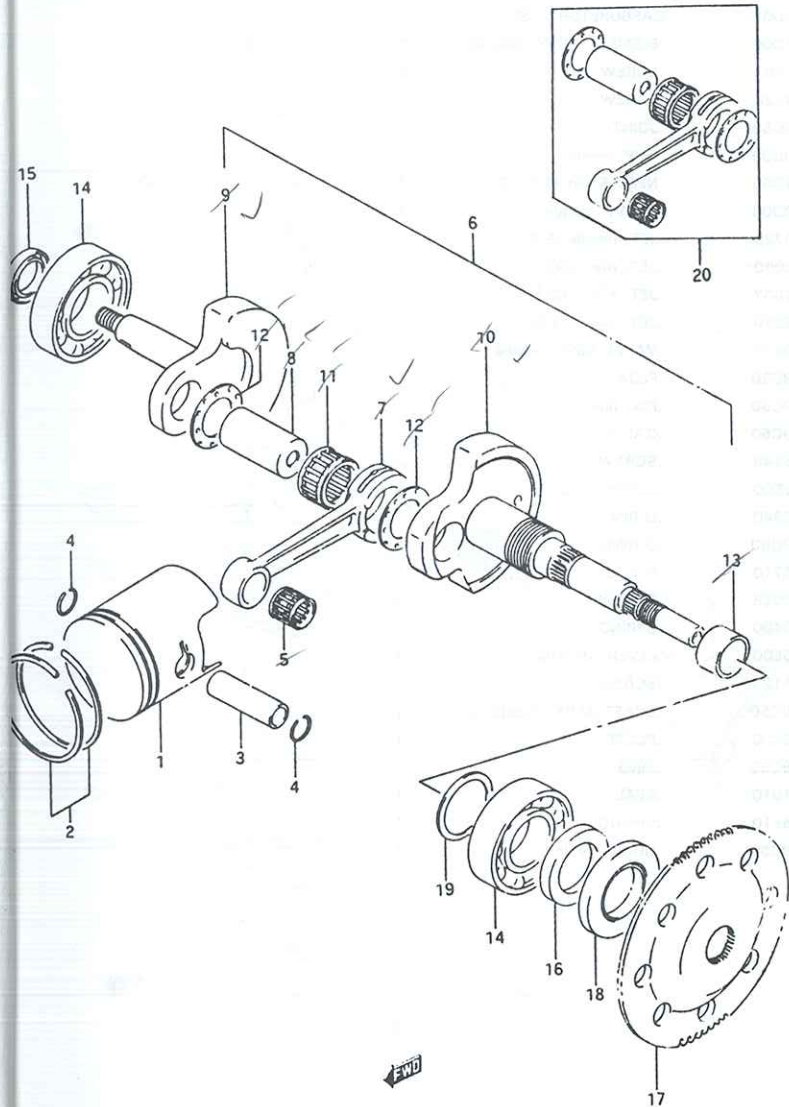

FIG. 4 (B-5) CRANKSHAFT

REF. NO.	PART NO.	DESCRIPTION	Q'TY	REMARKS
1-1	12110M41D00-0F0	PISTON	1	
1-2	12110M41D00-050	PISTON (OS:0.5)	1	
1-3	12110M41D00-100	PISTON (OS:1.0)	1	
2-1	12140-35510	RING SET, piston	1	
2-2	12140-35510-050	RING SET, piston (OS:0.5)	1	
2-3	12140-35510-100	RING SET, piston (OS:1.0)	1	
3	12151-35500	PIN, piston	1	
4	09381-12001	CIRCLIP	2	
5	09263-12023	BEARING, piston pin	1	
6	12200-41D00	CRANKSHAFT ASSY	1	
7	12161-04C00	.ROD, connecting	1	
8	12211-04C00	.PIN, crank	1	
9	12271-41D00	.CRANKSHAFT, RH	1	
10	12261-41D00	.CRANKSHAFT, LH	1	
11	09263-20068	.BEARING (20x26x14)	1	
12	09160-20010	.WASHER	2	
13	09180-18011	.SPACER	1	
14	09262-25070-0A0	BEARING (25x52x15)	2	
15	09283-17017	OIL SEAL, RH (17x27x6)	1	
16	09283-25083	OIL SEAL, LH (25x37x6)	1	
17	12622-04C00	GEAR, starter	1	
18	09284-24001	OIL SEAL (24x43x6)	1	
19-1	09181-25056	SHIM (T:0.85)	1	
19-2	09181-25057	SHIM (T:0.9)	1	
19-3	09181-25058	SHIM (T:0.95)	1	
19-4	09181-25059	SHIM (T:1.0)	1	
19-5	09181-25060	SHIM (T:1.05)	1	
19-6	09181-25061	SHIM (T:1.1)	1	
19-7	09181-25062	SHIM (T:1.15)	1	
19-8	09181-25063	SHIM (T:1.2)	1	
19-9	09181-25064	SHIM (T:1.25)	1	
19-10	09181-25065	SHIM (T:1.3)	1	
19-11	09181-25066	SHIM (T:1.35)	1	
19-12	09181-25067	SHIM (T:1.4)	1	
19-13	09181-25068	SHIM (T:1.45)	1	
19-14	09181-25069	SHIM (T:1.5)	1	
20	12105-04820	CON ROD SET	1	INCLUSIVE REF. NO. 5,7,8,11 & 12

2

FIG. 5

FIG. 5 (B-6) CARBURETOR

2

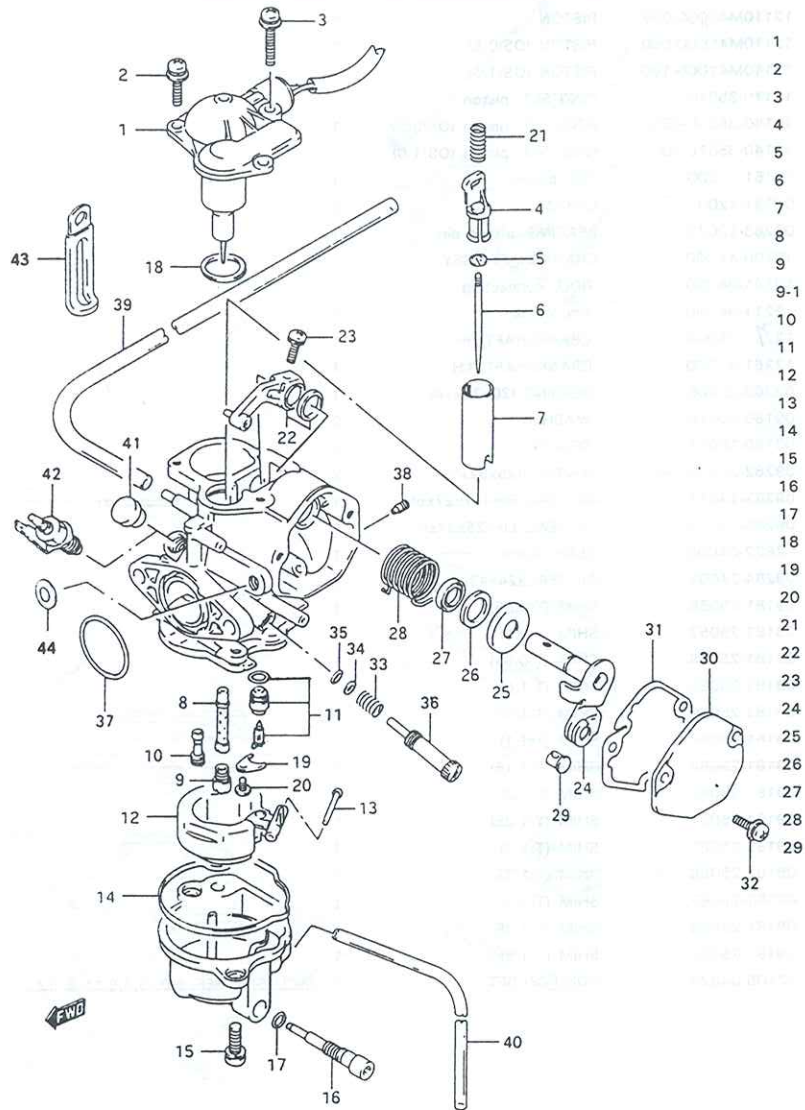

V100

REF. NO.	PART NO.	DESCRIPTION	Q'TY	REMARKS
	13200-41D02	CARBURETOR ASSY	1	
1	13401-41D00	.ELEMENT ASSY, thermo	1	
2	02112-34163	.SCREW	2	
3	13601-04228	.SCREW	1	
4	13511-29C50	.JOINT	1	
5	13394-40D00	.CLIP, needle	1	
6	13383-41D00	.NEEDLE, jet (3J22-3)	1	
7	13551-40D00	.VALVE, piston	1	
8	09494-00728	.JET, needle (E-2)	1	
9	09491-60010	.JET, main (60)	1	△ 60009
9-1	09491-62007	.JET, main (62.5)	1	
10	09492-22010	.JET, pilot (22.5)	1	
11	13370-02421	.VALVE ASSY, needle	1	
12	13250-29C50	.FLOAT	1	
13	13254-29C50	.PIN, float	1	
14	13258-29C50	.GASKET	1	
15	13601-05148	.SCREW	2	
16	13247-25E00	.SCREW, drain	1	
17	13278-02340	.O RING	1	
18	13278-39C60	.O RING	1	
19	13373-46710	.PLATE	1	
20	02112-03063	.SCREW	1	
21	13543-09400	.SPRING	1	
22	13540-25E00	.LEVER, throttle	1	
23	02112-34123	.SCREW	1	
24	13550-29C50	.SHAFT ASSY, throttle	1	
25	13557-09400	.PLATE	1	
26	13574-29C50	.RING	1	
27	13651-51010	.SEAL	1	
28	13573-25E10	.SPRING	1	
29	13569-29C50	.GUIDE, cable	1	

FIG. 5

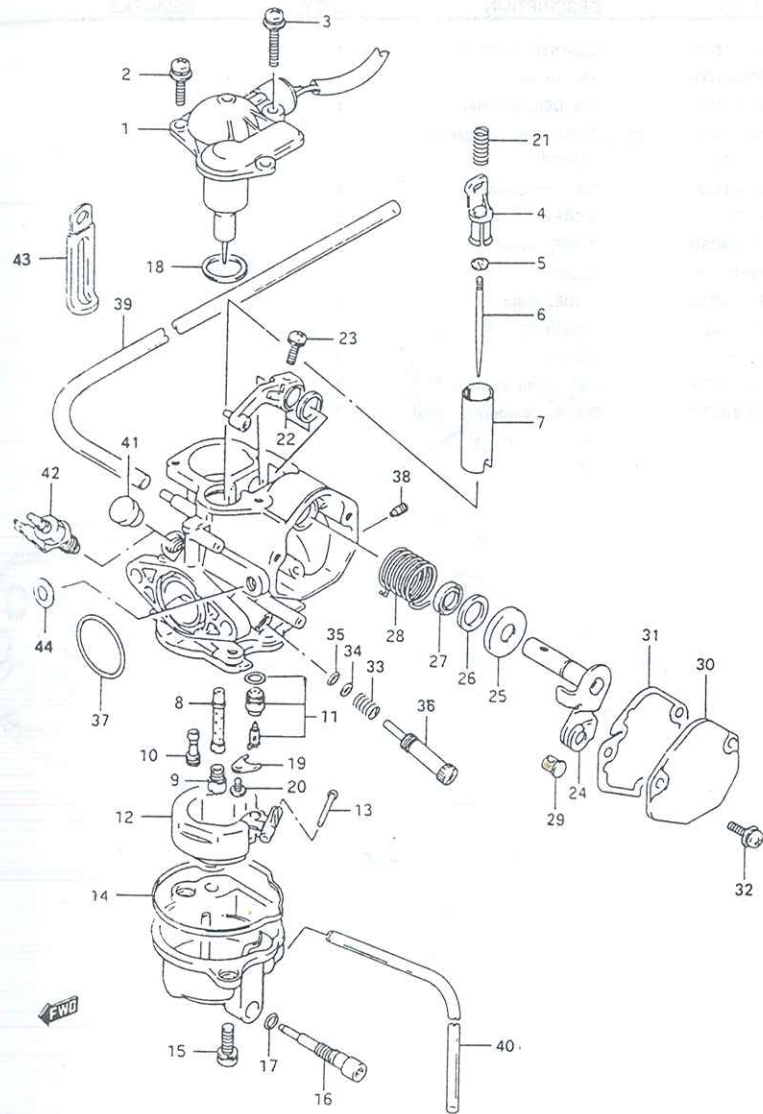

V100

FIG. 5 (B-7) CARBURETOR

REF. NO.	PART NO.	DESCRIPTION	Q'TY	REMARKS
30	13484-29C50	.COVER, throttle	1	
31	13237-29C50	.GASKET	1	
32	02112-74103	.SCREW	2	
33	13268-35010	.SPRING	1	
34	13291-35010	.WASHER	1	
35	13295-33010	.O RING	1	
36	13267-25E00	.ADJUSTER	1	
37	13278-29C50	.O RING	1	
38	09493-22005	.JET, air (1.3)	1	
39	13684-29C50	.HOSE (3.5x6.5x800)	1	L:800 → 750
40	09352-30503-600	.HOSE (3x5x300)	1	L:300 → 220
41	09250-06001	PLUG, heater boss	1	
42	13650-25E01	HEATER, carburetor	1	OPT
43-1	09404-06402	CLAMP (L:50)	2	
43-2	09404-06429	CLAMP (L:50)	2	
44	09168-06001	GASKET	1	

2

FIG. 6

FIG. 6 (B-8) AIR CLEANER

REF. NO.	PART NO.	DESCRIPTION	Q'TY	REMARKS
1	13700-41D00	CLEANER ASSY, air	1	
2	13780M41D10	.FILTER, air	1	
3	13791-41D00	.HOLDER, air filter	1	
4	13749-41D00	.PARTITION, air cleaner	1	
5	13821-39C00	.SLIDER	2	
6	13740-41D00	.CAP, air cleaner	1	
7	03141-06163	.SCREW	2	
8	13881-29C50	.TUBE, outlet	1	
9	09402-42306	.CLAMP	1	
10	13878-39C10	.TUBE, drain	1	
11	09137-06021	SCREW (6x20)	1	
12	03141-06303	SCREW	1	
13	13735M29C51	COVER, air cleaner	1	
14	13789-29C52	GUARD, carburetor mud	1	

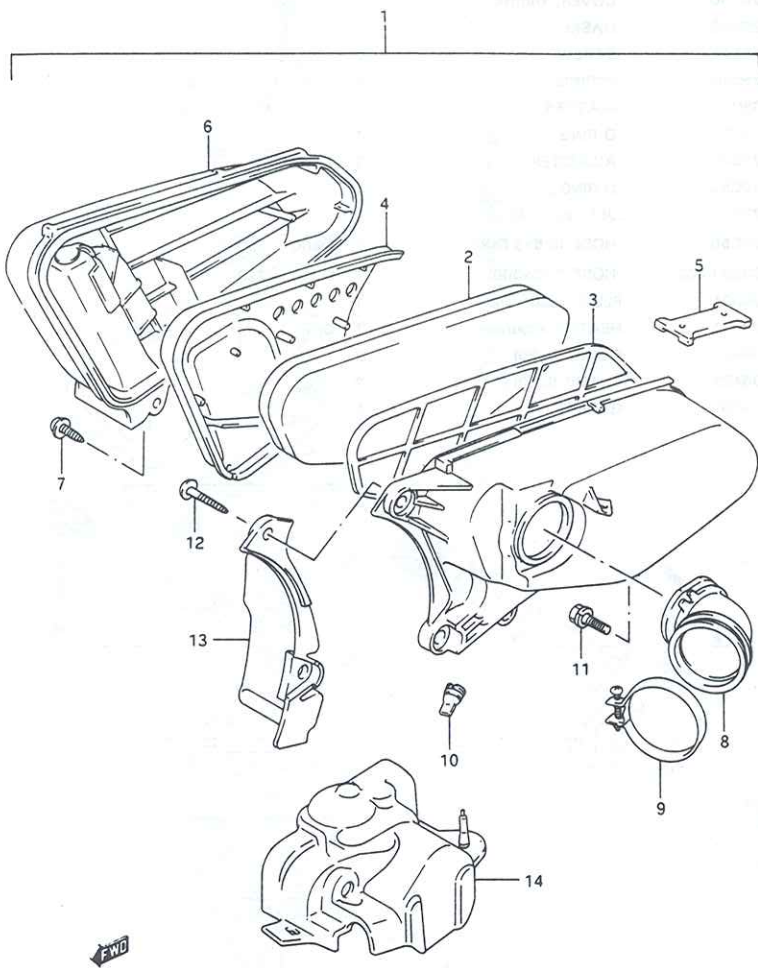

2

FIG. 7

FIG. 7 (C-2) MUFFLER

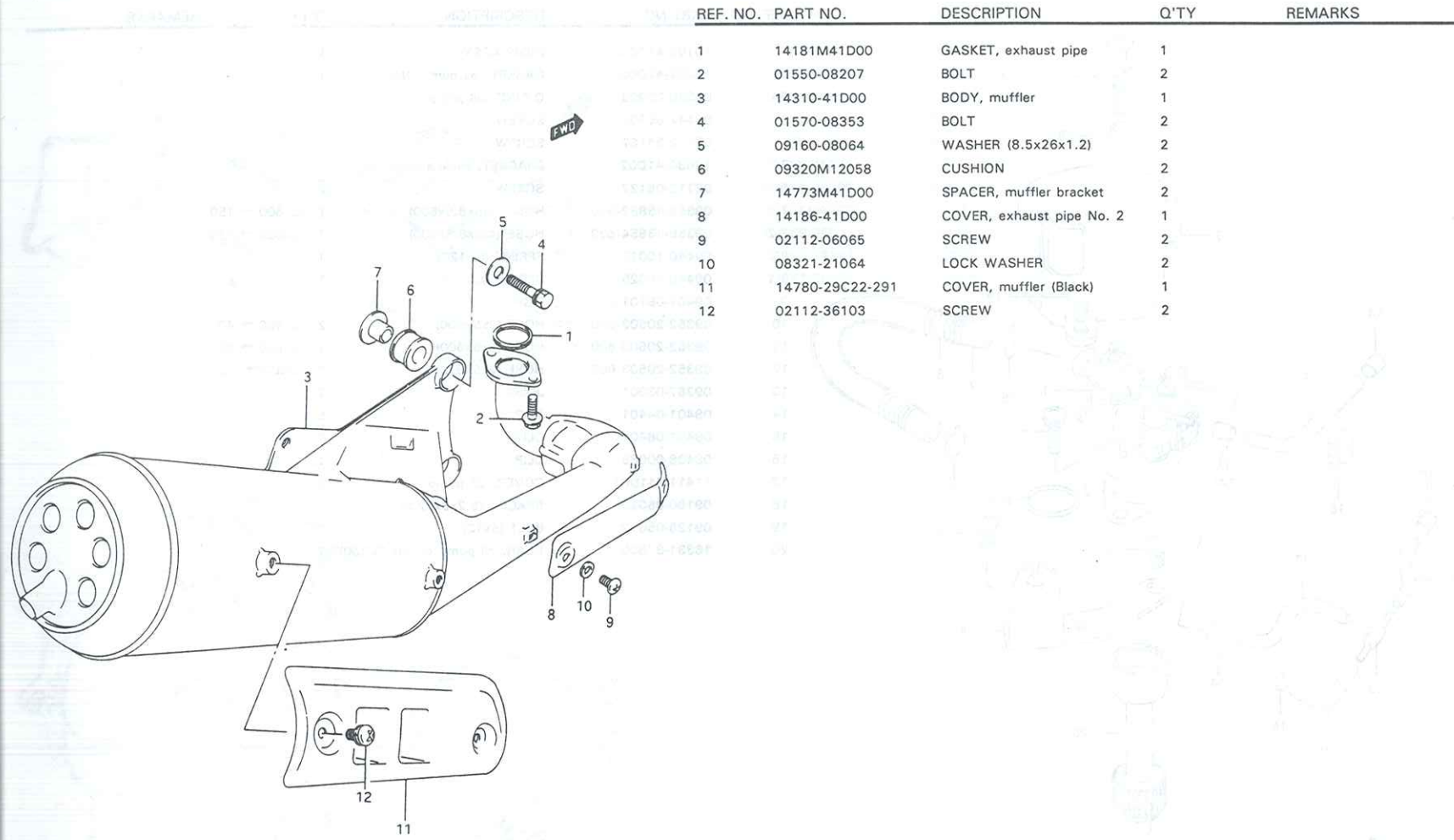

REF. NO.	PART NO.	DESCRIPTION	Q'TY	REMARKS
1	14181M41D00	GASKET, exhaust pipe	1	
2	01550-08207	BOLT	2	
3	14310-41D00	BODY, muffler	1	
4	01570-08353	BOLT	2	
5	09160-08064	WASHER (8.5x26x1.2)	2	
6	09320M12058	CUSHION	2	
7	14773M41D00	SPACER, muffler bracket	2	
8	14186-41D00	COVER, exhaust pipe No. 2	1	
9	02112-06065	SCREW	2	
10	08321-21064	LOCK WASHER	2	
11	14780-29C22-291	COVER, muffler (Black)	1	
12	02112-36103	SCREW	2	

2

FIG. 8

FIG. 8 (C-3) OIL PUMP

2

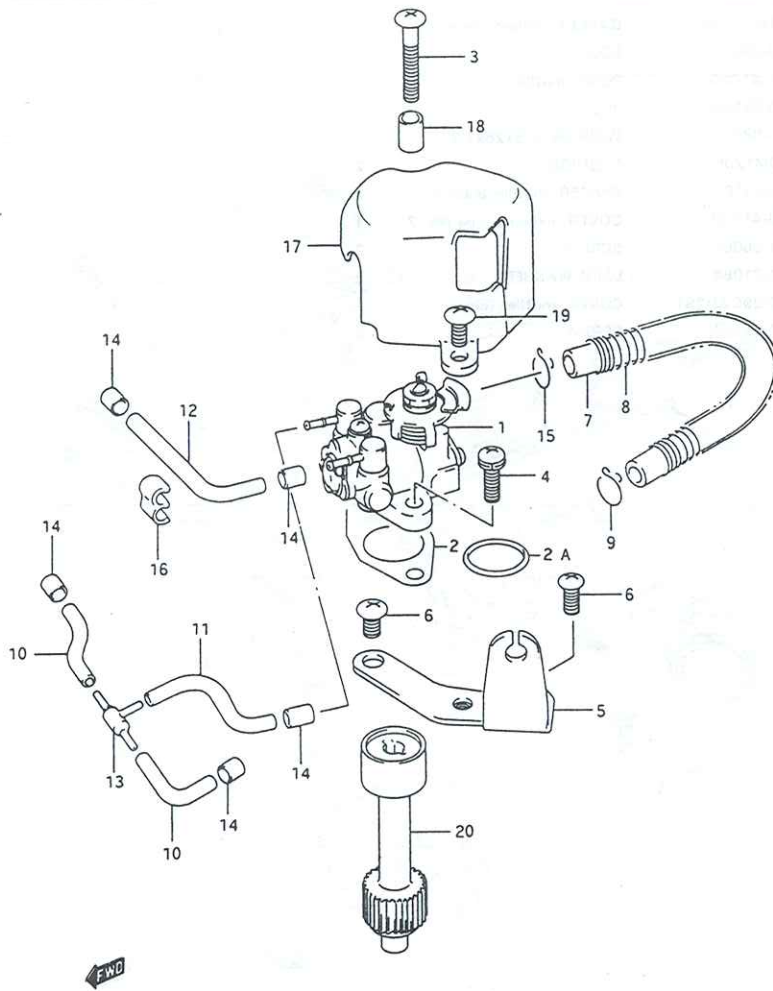

REF. NO.	PART NO.	DESCRIPTION	Q'TY	REMARKS
1	16100-41D04	PUMP ASSY, oil	1	
2	16731-41D00	GASKET, oil pump (NA)	1	
2A	09280-20003	O RING, oil pump	1	
3	02142-05307	SCREW	1	
4	02112-35167	SCREW	1	
5	16630-41D02	BRACKET, cable adjuster	1	
6	02112-06127	SCREW	2	
7-1	09359-45852-600	HOSE (4.5x8.5x600)	1	L: 600 → 150
7-2	09359-45854-600	HOSE (4.5x8.5x600)	1	L: 600 → 150
8	09440-10019	SPRING (L: 120)	1	
8-1	09440-10025	SPRING (L: 150)	1	
9	09401-09101	CLIP	1	
10	09352-20503-600	HOSE (2x5x600)	2	L: 600 → 40
11	09352-20503-600	HOSE (2x5x600)	1	L: 600 → 60
12	09352-20503-600	HOSE (2x5x600)	1	L:300 → 70
13	09367-03001	JOINT	1	
14	09401-04401	CLIP	5	
15	09401-08401	CLIP	1	
16	09408-00066	CLIP	1	
17	11411M41D01	COVER, oil pump	1	
18	09180-05025	SPACER (5.2x8x12.5)	1	
19	09128-05012	BOLT (5x12)	1	
20	16331-37B00	GEAR, oil pump driven (NT:30)	1	

FIG. 9

FIG. 9 (C-4) COOLING FAN

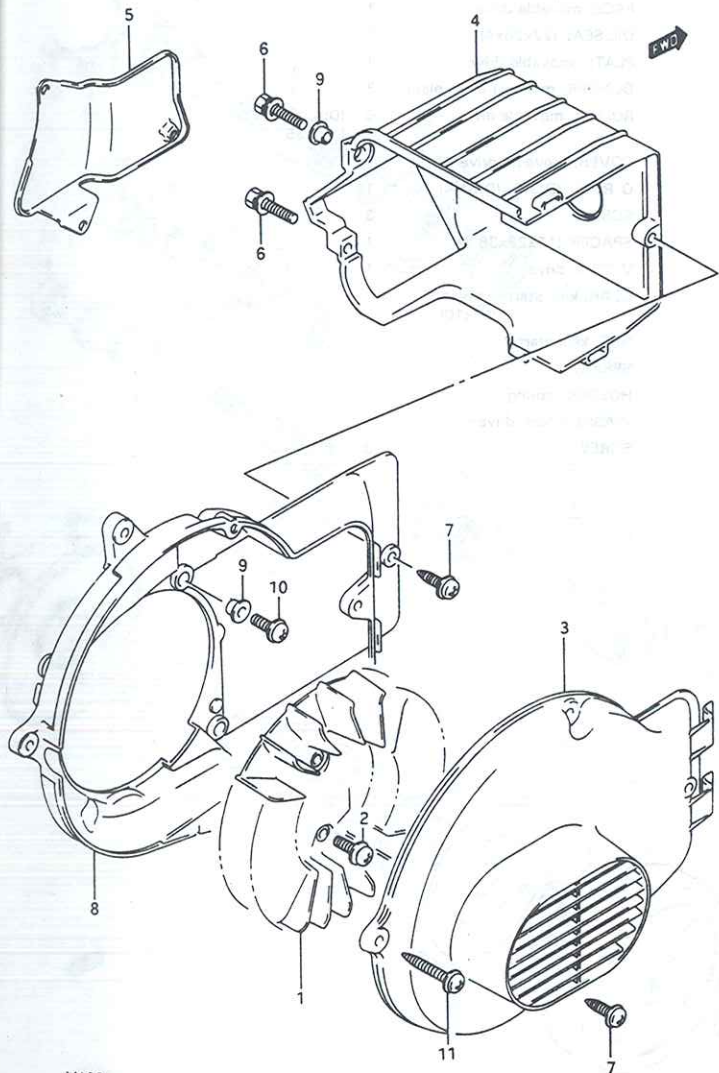

REF. NO.	PART NO.	DESCRIPTION	Q'TY	REMARKS
1	17110M04C00	FAN, cooling	1	
2	09136-06100	SCREW (6x12)	2	
3	17131M41D00	COWLING, fan	1	
4	17121M41D00	COWLING, cylinder	1	
5	17150-41D01	PLATE, cylinder cowlng	1	
6	09138-06045	BOLT, (6x25)	2	
7	03141-06203	SCREW	4	
8	17145M41D00	CASE, fan	1	
9	09169-06021	WASHER	5	
10	02112-16167	SCREW	4	
11	03141-06355	SCREW	1	

V100

2

2

FIG. 10

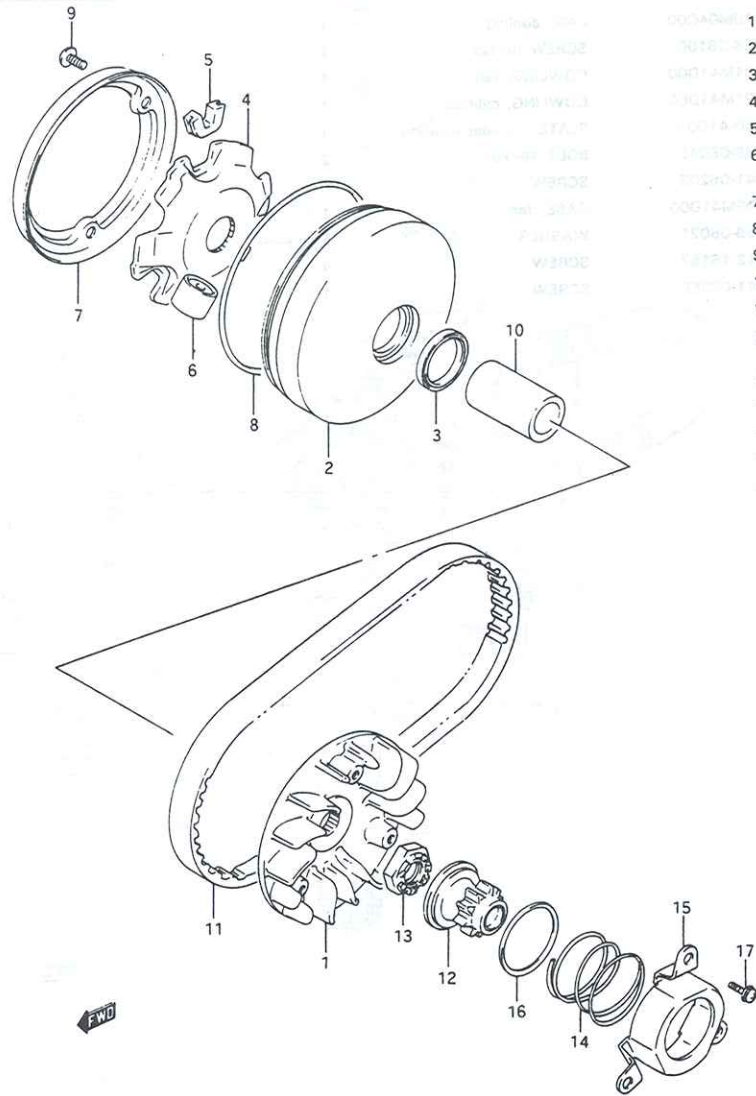
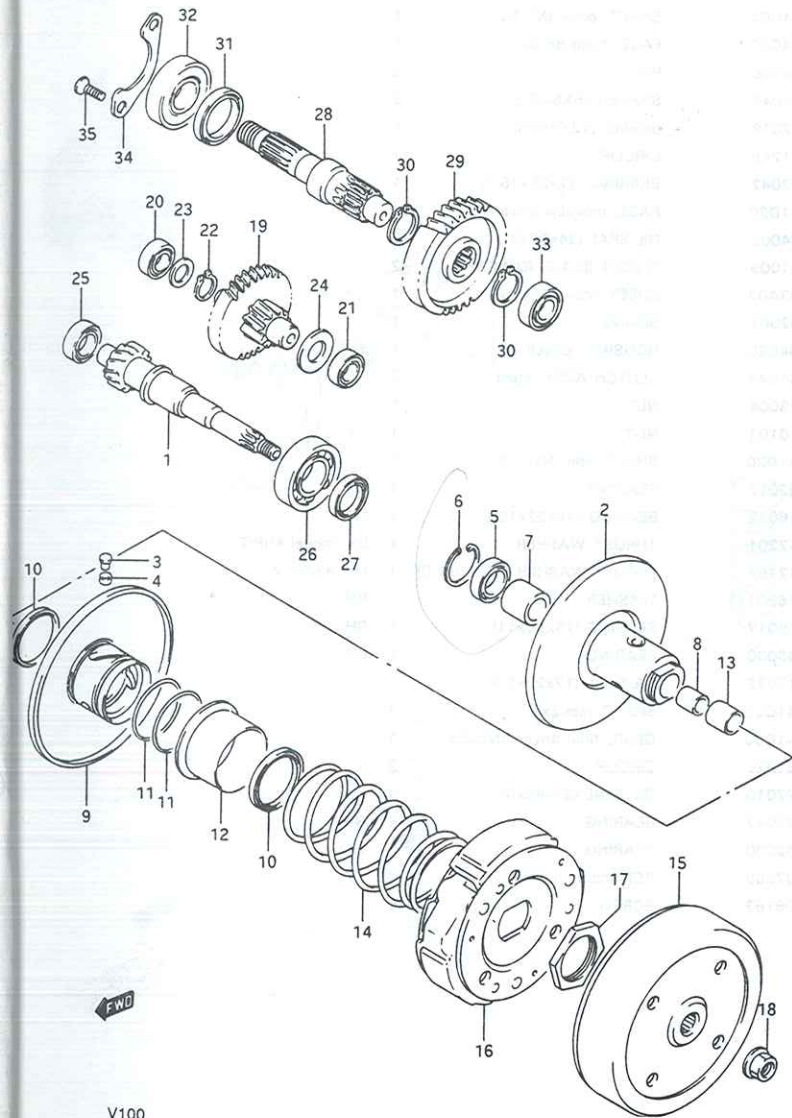

FIG. 10 (C-5) TRANSMISSION (1)

REF. NO.	PART NO.	DESCRIPTION	Q'TY	REMARKS
1	21110-41D00	FACE, fixed drive	1	
2	21120-04C03	FACE, movable drive	1	
3	09284-22003	OIL SEAL (22x28x4)	1	
4	21431-41D01	PLATE, movable drive	1	
5	21481-41D02	DUMPER, movable drive plate	3	
6	21650-41D12	ROLLER, movable drive	6	ID:4, OD:17 L:12.35
7	21122-37B01	COVER, movable drive	1	
8	09280-85003	O RING, (D:3.1, ID:84.4)	1	
9	02142-04103	SCREW	3	
10	09180-16044	SPACER (16x22x38.9)	1	
11	27601-04C03	V BELT, drive	1	
12	26280-41D01	GEAR, kick starter driven (NT:10)	1	
13	26282-41D00	NUT, kick starter	1	
14	09440-33003	SPRING	1	
15	26283-41D02	HOLDER, spring	1	
16	26284-41D00	WASHER, kick driven	1	
17	02112-74103	SCREW	3	

FIG. 11



V100

FIG. 11 (C-6) TRANSMISSION (2)

REF. NO.	PART NO.	DESCRIPTION	Q'TY	REMARKS
1	24131-41D00	SHAFT, drive (NT:14)	1	
2	21210-41D00	FACE, fixed driven	1	
3	09201-05006	PIN	3	
4	09180-05042	SPACER (6x8x3.5)	3	
5	09262-15028	BEARING (15x28x7)	1	
6	08331-41286	CIRCLIP	1	
7	09263-17042	BEARING (17x25x16.7)	1	
8	09180-12129	SPACER (12x17x19)	1	
9	21240-41D00	FACE, movable driven	1	
10	09283-34007	OIL SEAL (34x41x4)	2	
11	09280-41005	O RING (D:4.6, ID:41.9)	2-04C	
12	21471-03A02	SHEET, movable face	1	
13	21213-41D00	SPACER, fixed driven face	1	
14	09440-52007	SPRING	1	
15	21220-04C11	HOUSING, clutch	1	
16	21501-41D00	CLUTCH ASSY, shoe (NA)	1	
17	09140-28004	NUT	1	
18	08316-16108	NUT	1	
19	24150-41D00	SHAFT, idle (NT:31/10)	1	
20	08113-62017	BEARING	1	RH
21	09263-16012	BEARING (16x22x12)	1	LH
22	08331-31156	CIRCLIP	1	
23	08211-12201	THRUST WASHER	1	LH
24	08211-16301	WASHER	1	RH
25	09262-15017	BEARING (15x35x11)	1	RH
26	09262-20130	BEARING (20x47x14)	1	LH
27	09283-20052	OIL SEAL (20x28x5)	1	
28	24141-41D00	SHAFT, rear axle	1	
29	24371-41D00	GEAR, final driven (NT:35)	1	
30	08331-31226	CIRCLIP	2	
31	09283-27014	OIL SEAL (27x40x6)	1	
32	08310-62047	BEARING	1	RH
33	08110-62030	BEARING	1	LH
34	24751-07900	RETAINER, rear axle shaft bearing	1	
35	02122-06167	SCREW	2	

2

FIG. 11A

FIG. 11A (C-8) TRANSMISSION (2) (F. No. 216955-)

2

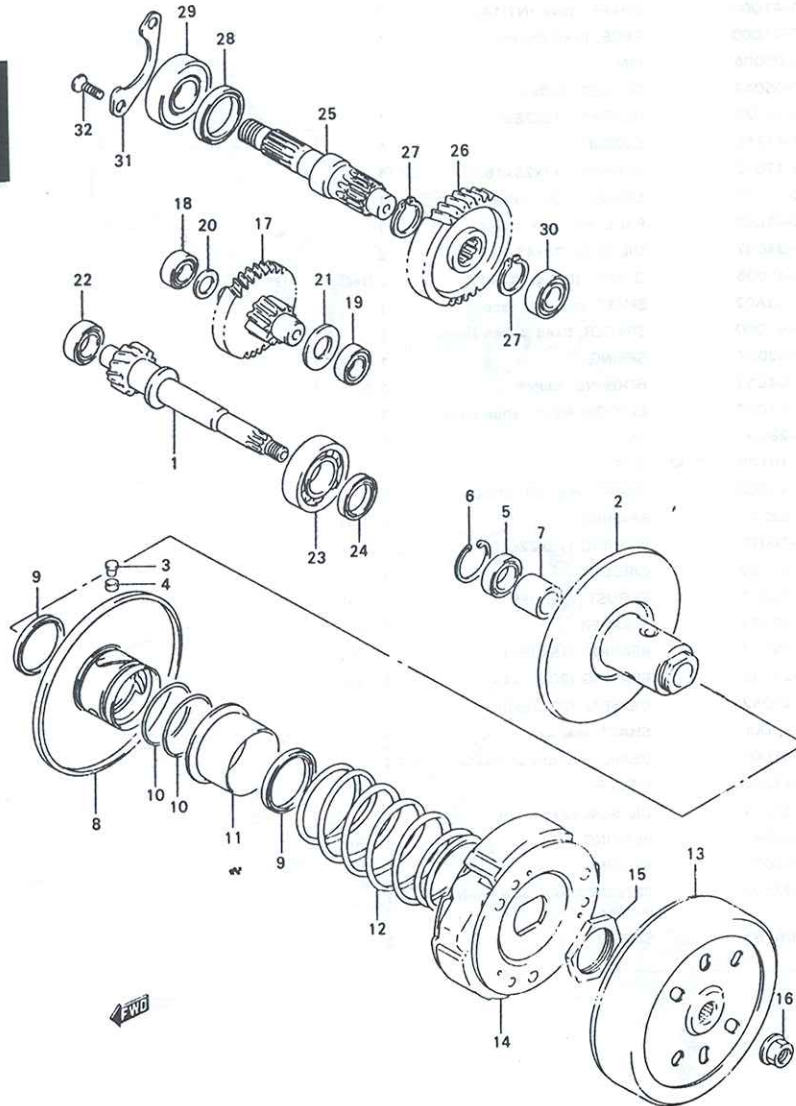

REF. NO.	PART NO.	DESCRIPTION	Q'TY	REMARKS
1	24131-04C01	SHAFT, drive (NT:14)	1	
2	21210-04C10	FACE, fixed driven	1	
3	09201-05006	PIN	3	
4	09180-05042	SPACER (6X8X3.5)	3	
5	09262-12018	bearing (12X24X6)	1	
6	08331-41246	CIRCLIP	1	
7	09263-17042	BEARING (17x25x16.7)	1	
8	21240-41D20	FACE, movable driven	1	
9	09284-34002	OIL SEAL (34x39x3)	2	
10	09280-41005	O RING (D:4.6, ID:41.9)	2	
11	21471-03A03	SHEET, movable face	1	
12	09440-52007	SPRING	1	
13	21220-04C20	HOUSING, clutch	1	
14	21501-41D41	CLUTCH ASSY, shoe	1	2041D90
15	09140-28004	NUT	1	
16	08316-10103	NUT	1	
17	24150-41D20	SHAFT, idle (NT: 31/10)	1	
18	08113-62017	BEARING	1	RH
19	09263-16012	BEARING (16x22x12)	1	LH
20-1	08211-12201	THRUST WASHER	1	LH, model M/P/T
20-2	09181-12167	THRUST WASHER (12x20x1.0)	1	LH, model V
21	08211-16301	WASHER	1	RH
22	09262-15017	BEARING (15x35x11)	1	RH
23	08113-63030	BEARING	1	LH
24	09283-17023	OIL SEAL (17x28x5.5)	1	
25	24141-41D00	SHAFT, rear axle	1	
26	24371-41D00	GEAR, final driven (NT:35)	1	
27	08331-31226	CIRCLIP	2	
28	09283-27010	OIL SEAL (27x40x6)	1	
29	08130-62047	BEARING	1	RH
30	08110-62030	BEARING	1	LH
31	24751-07900	RETAINER, bearing	1	
32	02122-06163	SCREW	2	

FIG. 12

FIG. 12 (C-7) KICK STARTER

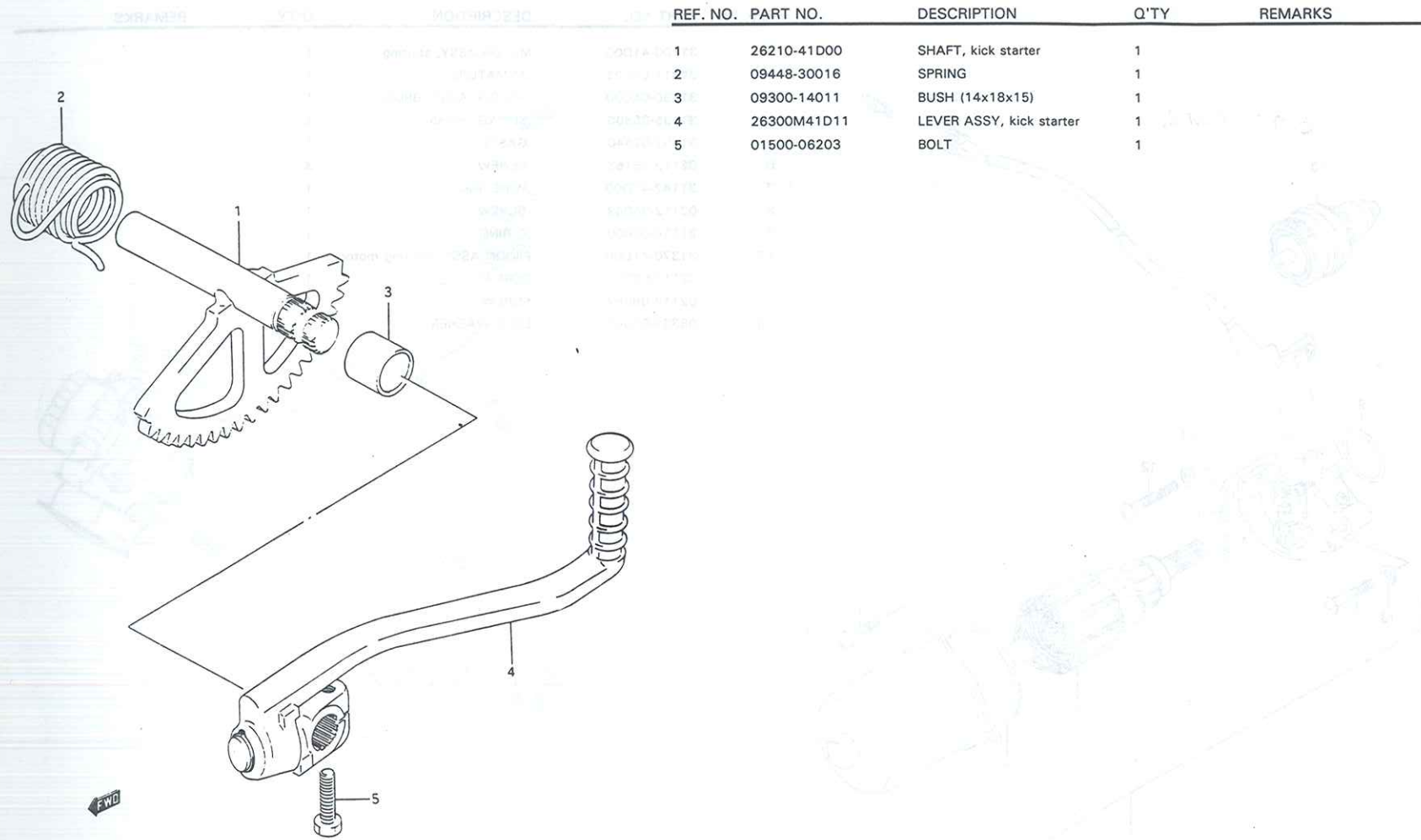

REF. NO.	PART NO.	DESCRIPTION	Q'TY	REMARKS
1	26210-41D00	SHAFT, kick starter	1	
2	09448-30016	SPRING	1	
3	09300-14011	BUSH (14x18x15)	1	
4	26300M41D11	LEVER ASSY, kick starter	1	
5	01500-06203	BOLT	1	

3

FIG. 13

FIG. 13 (D-2) STARTING MOTOR

REF. NO.	PART NO.	DESCRIPTION	Q'TY	REMARKS
1	31100-41D00	MOTOR ASSY, starting	1	
2	31311-04C01	.ARMATURE	1	
3	31130-04C00	.HOLDER ASSY, BRUSH	1	
4	31135-05B00	.SPRING, brush	2	
5	31157-02540	.GASKET	1	
6	02112-35163	.SCREW	3	
7	31142-41D00	.WIRE, lead	1	
8	02112-34063	.SCREW	1	
9	31156-05B00	.O RING	1	
10	31370-41D00	PINION ASSY, starting motor	1	
11	02112-06307	SCREW	1	
12	02112-06357	SCREW	1	
13	08321-01067	LOCK WASHER	2	

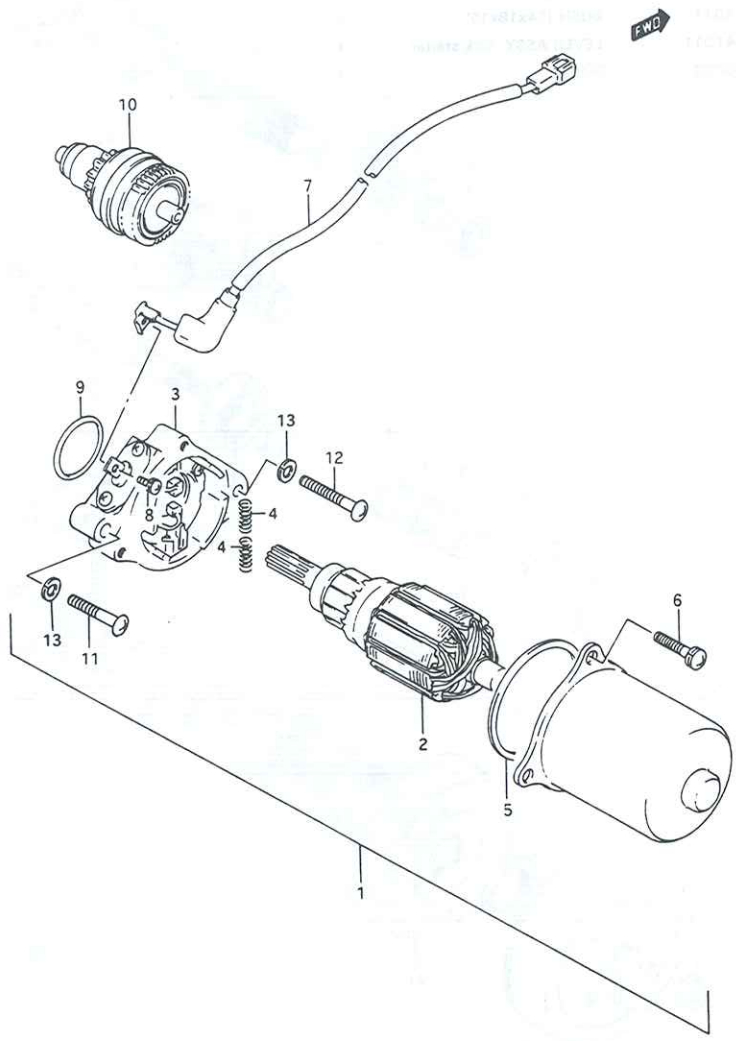

3

FIG. 16
FIG. 14

FIG.14 (D-3) MAGNETO

REF. NO.	PART NO.	DESCRIPTION	Q'TY	REMARKS
1	32101-41D01	STATOR	1	
2	32102-41D01	ROTOR	1	
3	09125-06081	SCREW (L:22)	2	
4	08316-16108	NUT	1	
5	08341-31039	KEY	1	
6	32371-41D00	CLAMP, magneto lead	1	
7	02112-05103	SCREW	1	

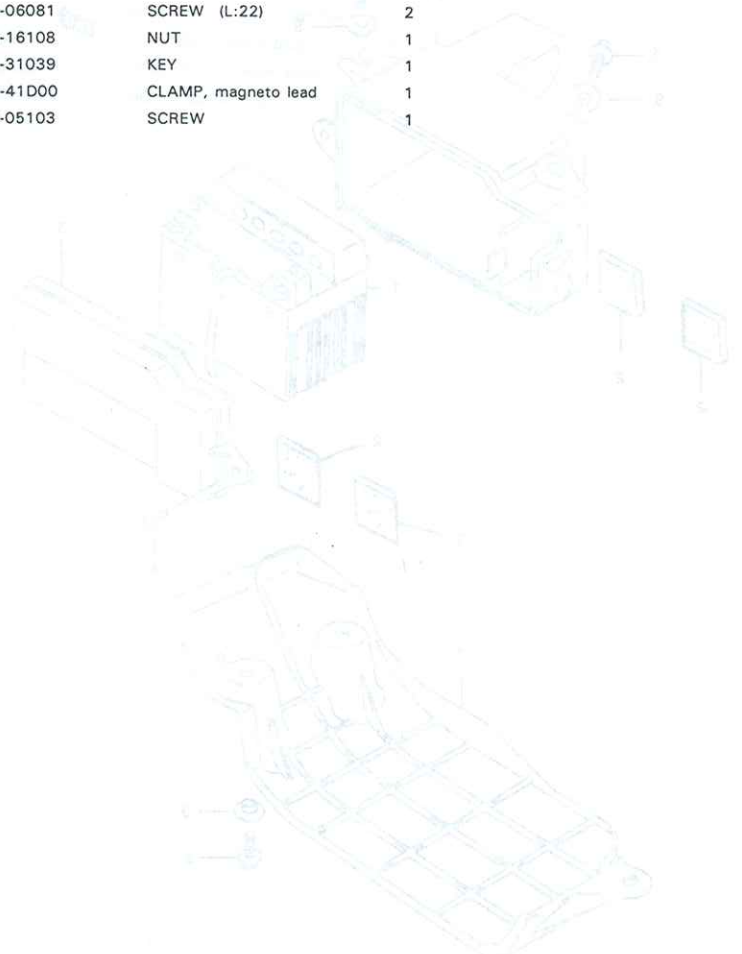
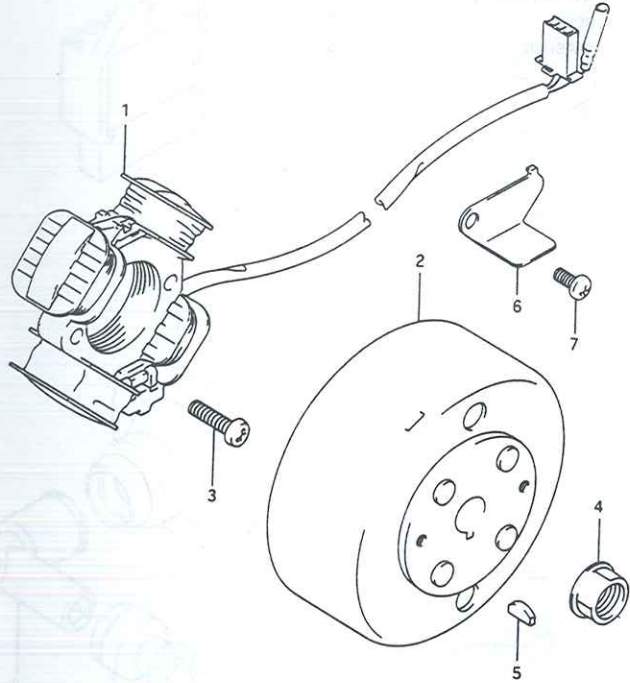

3

FIG. 15

FIG. 15 (D-4) BATTERY

3

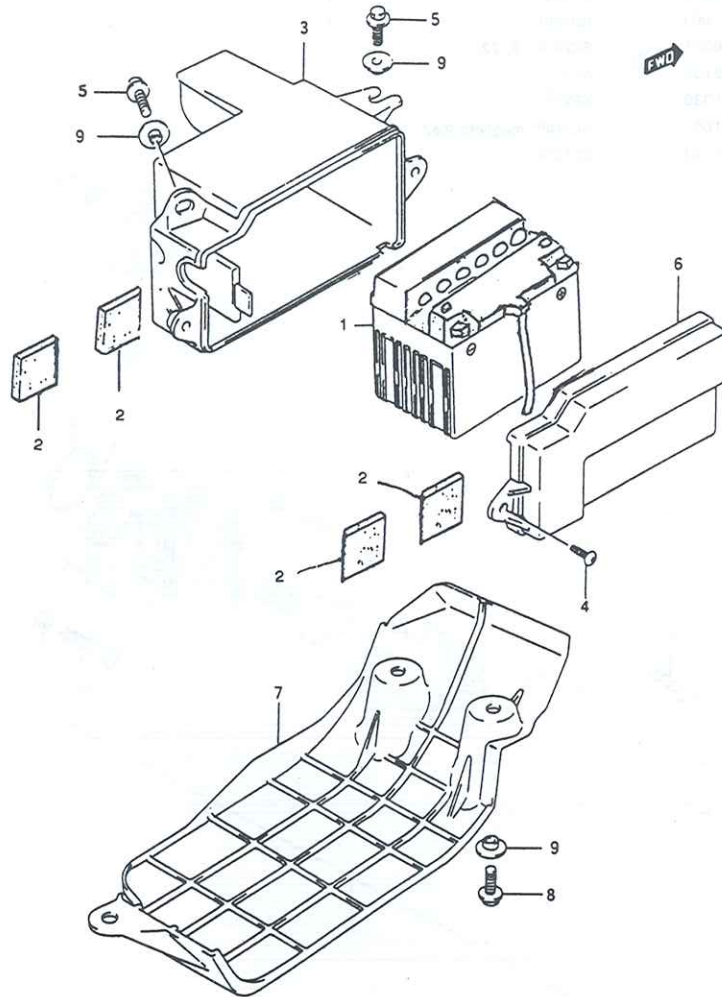

REF. NO.	PART NO.	DESCRIPTION	Q'TY	REMARKS
1	33610M40D50	BATTERY (YB4C-C)	1	
2	33652M35400	PROTECTOR (40x25x2)	4	
3	41541M40D00	HOLDER, battery	1	
4	09139-06077	SCREW (6x12)	2	
5	01550-06127	BOLT	2	
6	41542M40D00	CAP, battery holder	1	
7	41545M40D00	GUARD, battery holder	1	
8	01550-06163	BOLT	3	
9	09169-06031	WASHER	5	

V100

FIG. 16

FIG. 16 (D-5) ELECTRICAL

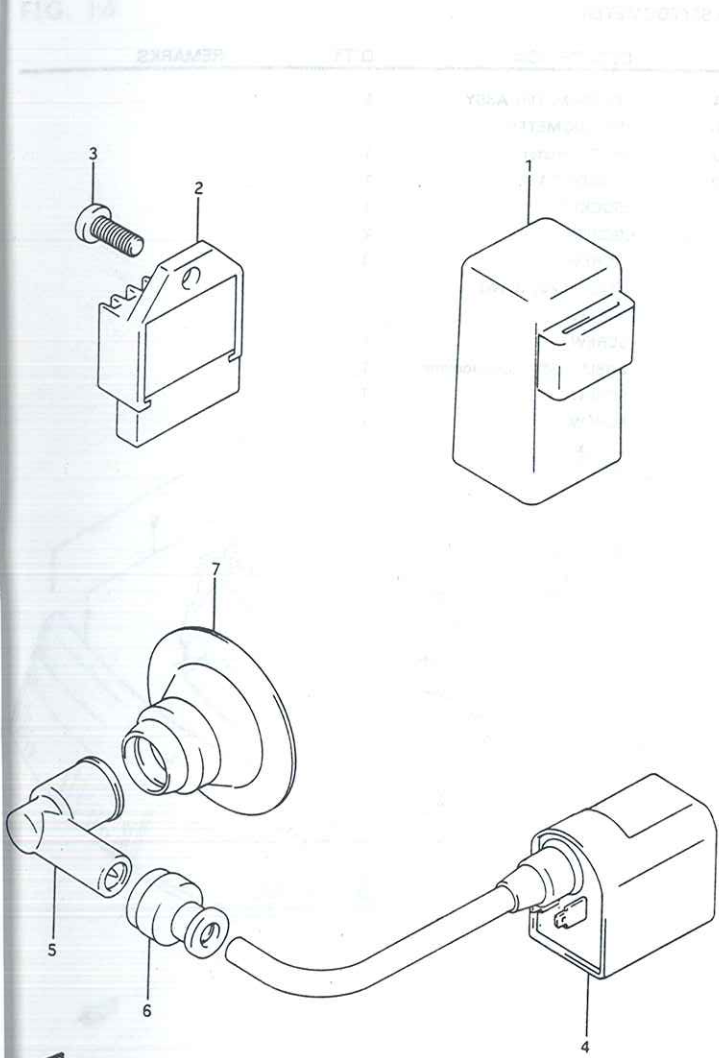

REF. NO.	PART NO.	DESCRIPTION	Q'TY	REMARKS
1	31800-19D00	RELAY ASSY, starting motor	1	
2	32800-40D10	RECTIFIER ASSY	1	
3	02112-06163	SCREW	1	
4	33410-41D00	UNIT & COIL ASSY, ignition	1	
5	33510-35411	CAP ASSY, spark plug	1	
6	33542-38B00	SEAL, high tension cord	1	
7	33543-02100	BOOT, spark plug	1	

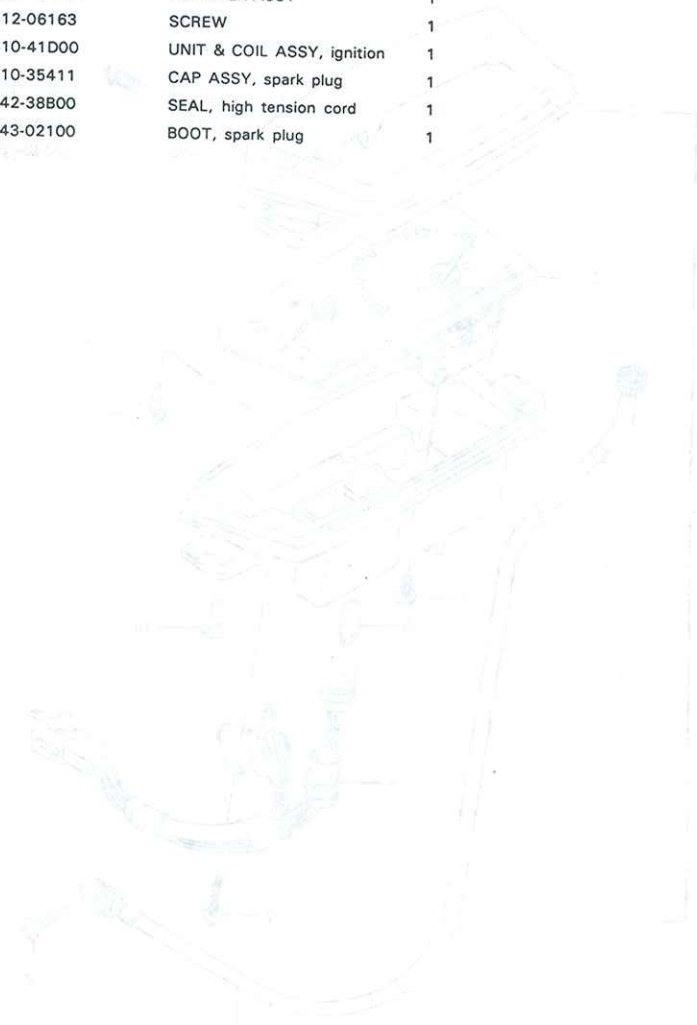

3

V100

FIG. 17

FIG. 17 (D-6) SPEEDOMETER

REF. NO.	PART NO.	DESCRIPTION	Q'TY	REMARKS
1	34100M41D24	SPEEDOMETER ASSY	1	
2	34120M41D20	.SPEEDOMETER	1	
3	34150M40D00	.HOOD, meter	1	
4	34111M41D00	.LOWER CASE	1	
5	34173-41D00	.SOCKET	1	
6	02112-74103	.SCREW	2	
7	34383-09400	.SCREW	3	
8	09471-12028	.BULB (12V, 3.4W)	2	
9	03541-05163	SCREW	1	
10	03541-05203	SCREW	2	
11	34910M41D00	CABLE ASSY, speedometer	1	
12-1	02112-05164	SCREW	1	
12-2	02112-05163	SCREW	1	

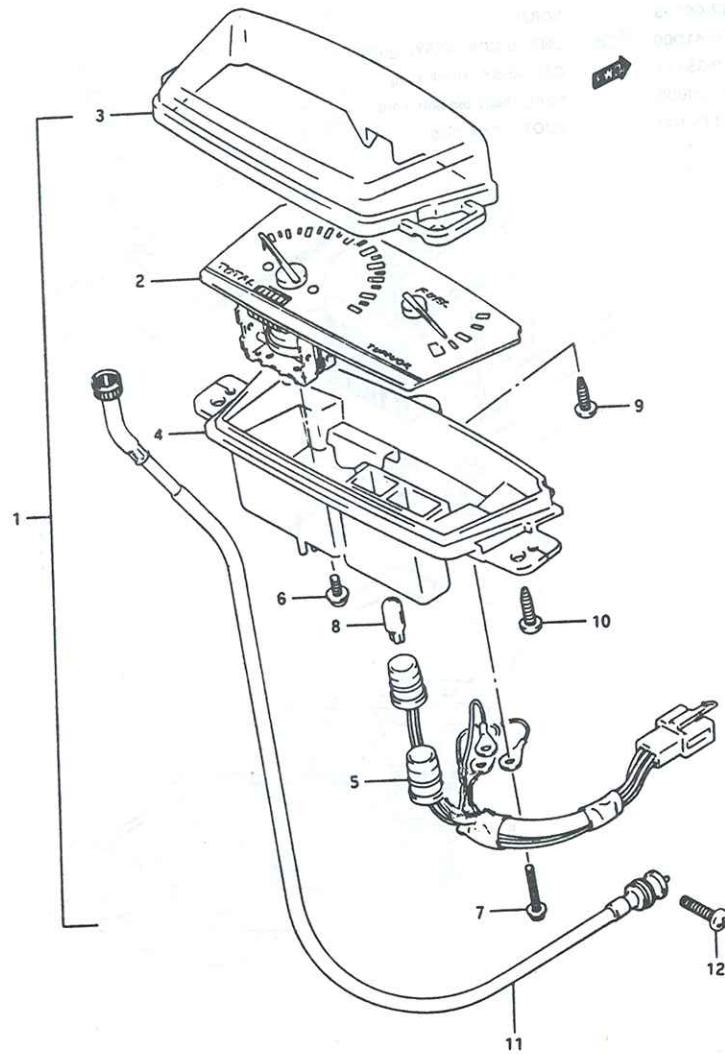

FIG. 18

FIG. 18

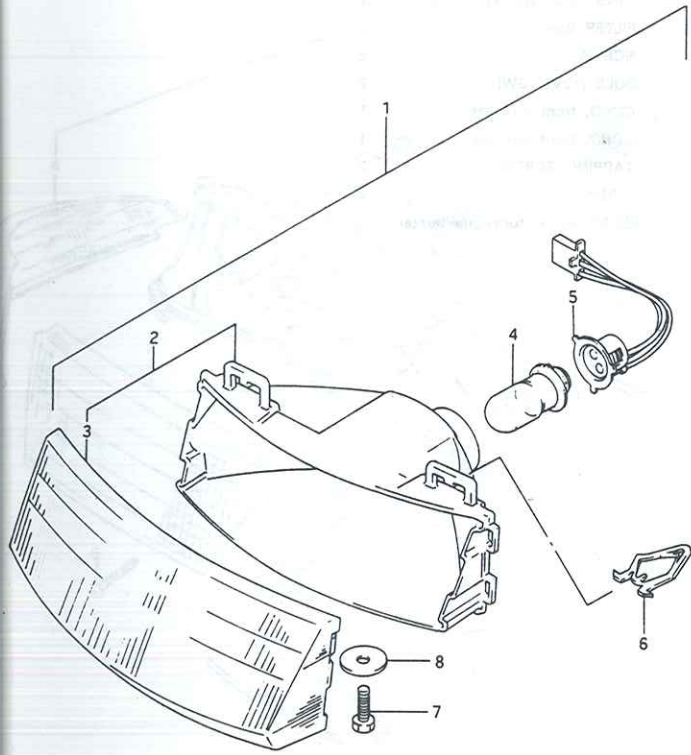

FIG. 18 (D-7) HEAD LAMP

REF. NO.	PART NO.	DESCRIPTION	Q'TY	REMARKS
1	35100-40D01	HEAD LAMP ASSY	1	
2	35121-39C00	.UNIT, head lamp	1	
3	35124-39C00	.LENS	1	
4	09471-12171	.BULB (12V, 30/30W)	1	
5	35171-16A00	.SOCKET	1	
6	35194-39C00	STOPPER, head lamp	2	
7	09128-05101	SCREW	1	
8	09160-05501	WASHER (5.5x20x1.2)	1	

3

V100

FIG. 19

FIG. 19 (D-8) FRONT TURN SIGNAL LAMP

3

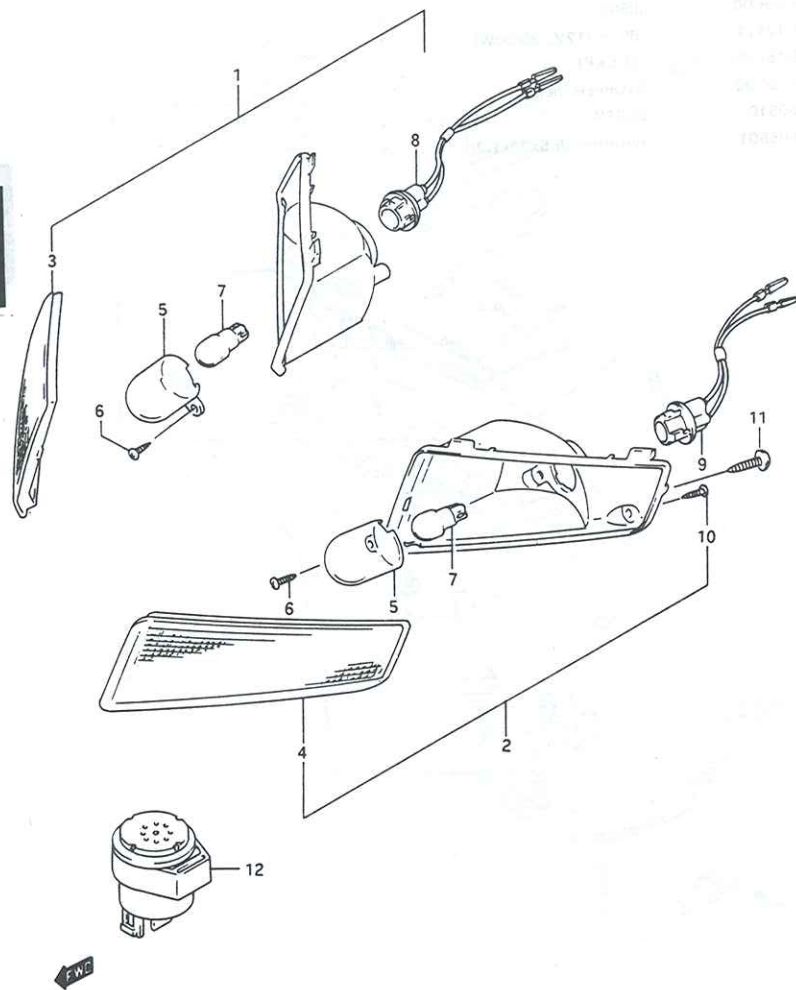

REF. NO.	PART NO.	DESCRIPTION	Q'TY	REMARKS
1	35601-40D00	LAMP ASSY, front turnsignal RH	1	
2	35602-40D00	LAMP ASSY, front turnsignal LH	1	
3	35612-40D00	.LENS front turn RH	1	
4	35632-40D00	.LENS front turn LH	1	
5	35614-40D00	.FILTER, valve	2	
6	03211-04123	.SCREW	2	
7	09471-12114	.BULB (12V, 10W)	2	
8	35618-40D00	.CORD, front turn RH	1	
9	35638-40D00	.CORD, front turn LH	1	
10	09132-03012	.TAPPING SCREW	2	
11	03541-04163	SCREW	2	
12	38610-36C00	RELAY ASSY, turnsignal/buzzer	1	

FIG. 20

FIG. 20 (D-9) REAR COMBINATION LAMP

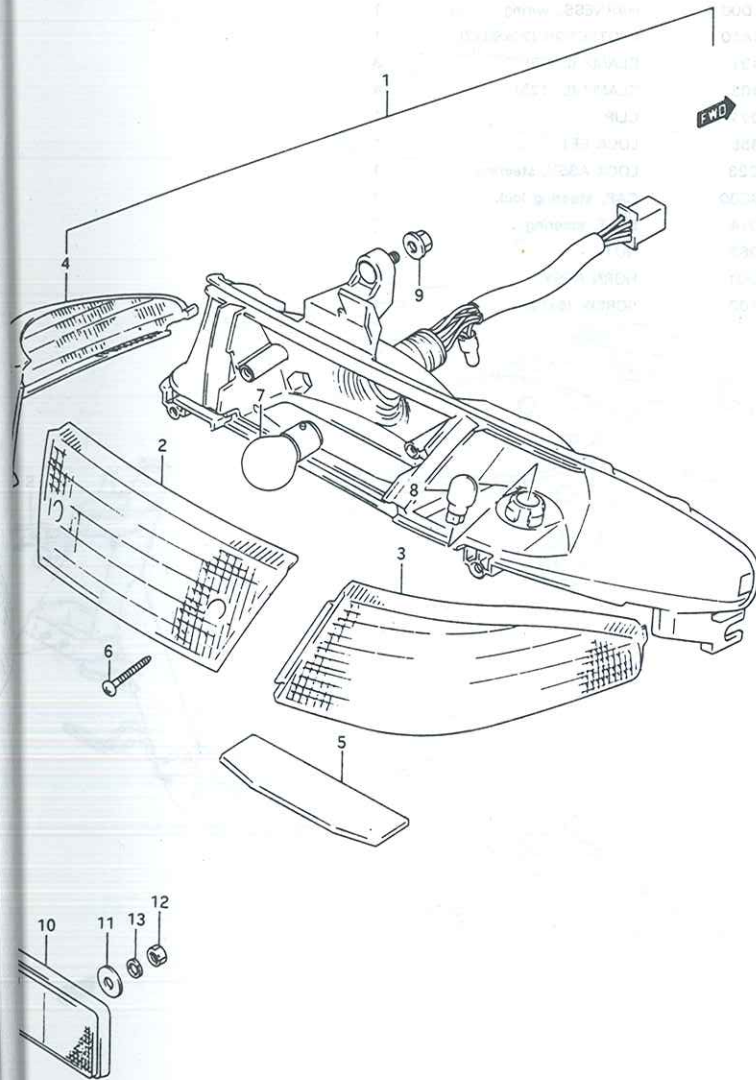

REF. NO.	PART NO.	DESCRIPTION	Q'TY	REMARKS
1	35710-40D00	LAMP ASSY, rear combination	1	
2	35712-40D00	.LENS, rear lamp	1	
3	35652-40D00	.LENS, rear turn RH	1	
4	35672-40D00	.LENS, rear turn LH	1	
5	35912-40D00	.LENS, license	1	
6	03211-04207	.SCREW	2	
7	09471-12119	.BULB (12V, 18/5W)	1	
8	09471-12114	.BULB (12V, 10W)	2	
9	08316-10063	NUT	3	
10	35970-29C00	REFLECTION, rear	1	
11	09160-05016	WASHER (5.2x14x1)	1	
12	08310-00053	NUT	1	
13	08321-01053	LOCK WASHER	1	

V100

3

FIG. 21

FIG. 21 (D-10) WIRING HARNESS

3

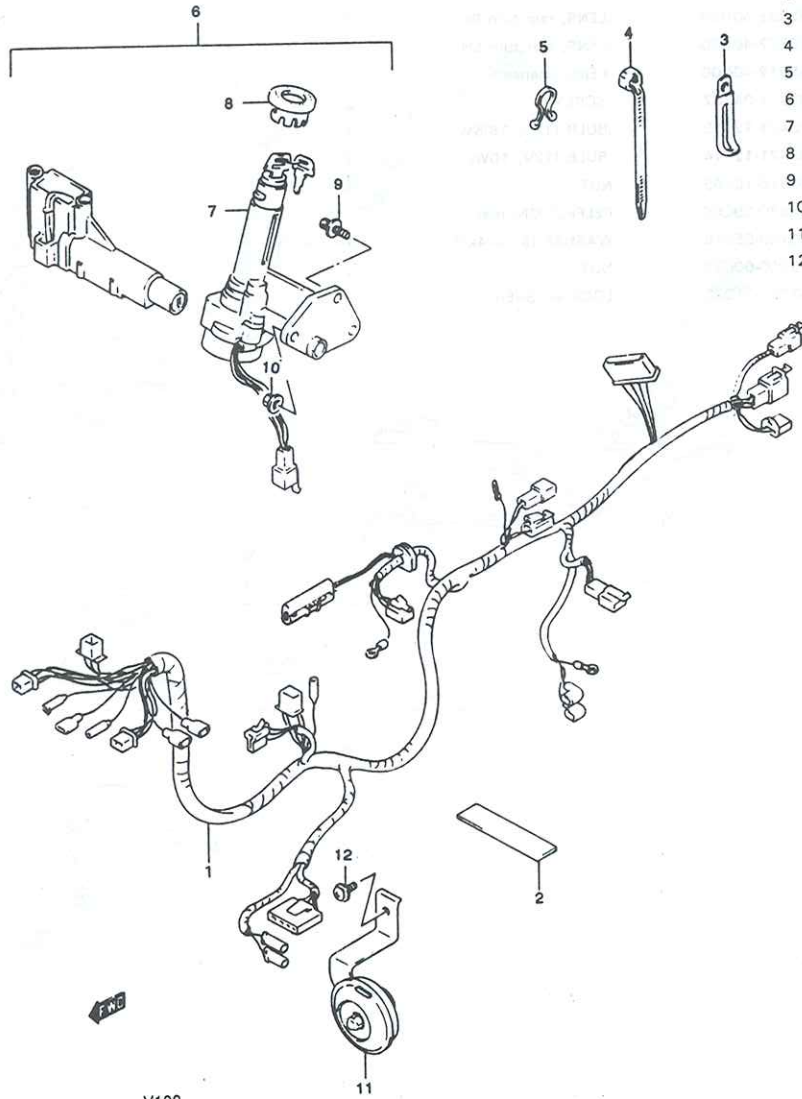

REF. NO.	PART NO.	DESCRIPTION	Q'TY	REMARKS
1	36610M41D00	HARNESS, wiring	1	
2	33652M38A10	PROTECTOR (20x90x2)	1	
3	09404-06431	CLAMP (L: 85)	3	
4	09407-14403	CLAMP (L: 125)	4	
5	09408-00021	CLIP	1	
6	37100-29855	LOCK SET	1	
7	37100-29C23	LOCK ASSY, steering	1	
8	37155M29C00	CAP, steering lock	1	
9	09139-06014	BOLT, steering	1	
10	08316-20063	NUT	1	
11	38501-40D01	HORN ASSY	1	
12	09136-06100	SCREW (6x12)	1	

V100

FIG. 22

FIG. 22 (E-2) FRAME

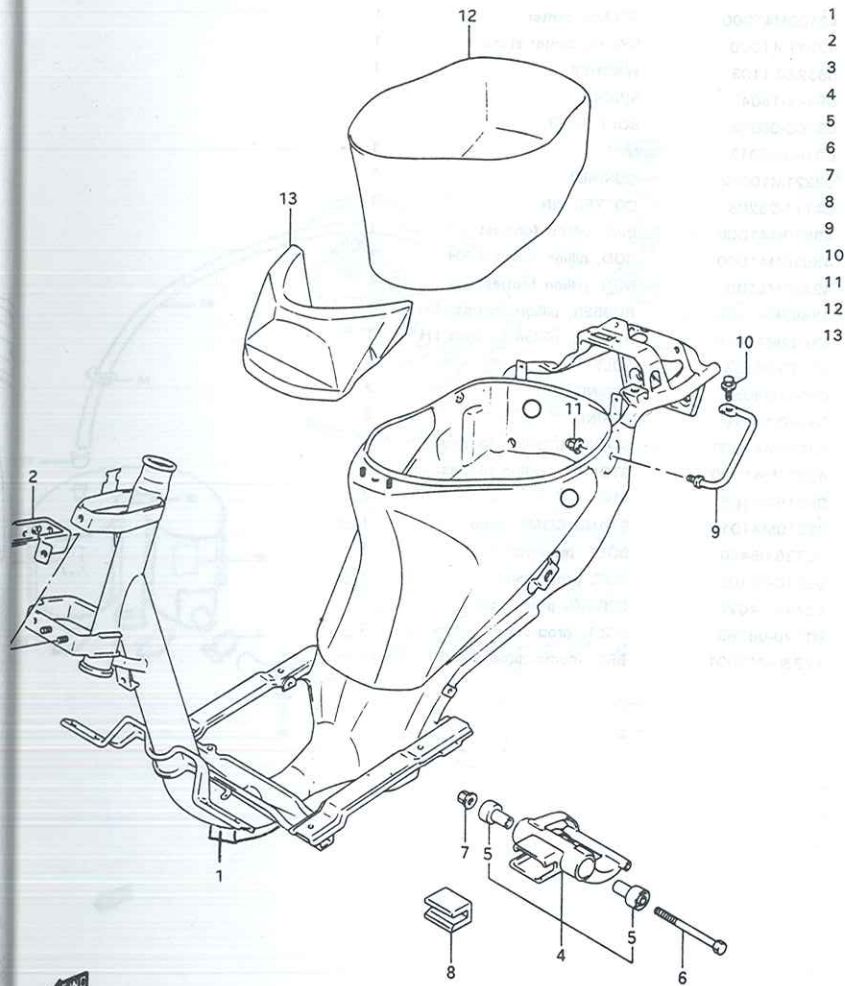

REF. NO.	PART NO.	DESCRIPTION	Q'TY	REMARKS
1	41100M41D01	FRAME (ALL COLOURS)	1	
2	41150M29C03	BRACKET, front leg shield	1	
3	09159-06017	NUT	2	
4	41180-41810	BRACKET SET, crankcase	1	
5	09319-12048	.BUSH (12x34.1x58.5)	2	
6	09103-12045	BOLT (12x140)	1	
7	08319-31126	NUT	1	
8	41185-41D00	CUSHION, swing stop	1	
9	43980-40D00	GRIP, stand	1	
10	01517-08125	BOLT	1	
11	08313-21087	NUT	1	
12	92211-40D00-5LZ	COVER, helmet (Blue)	1	
13	92221M40D01	GUIDE, cover helmet	1	

4

FIG. 23

FIG. 23 (E-30) STAND

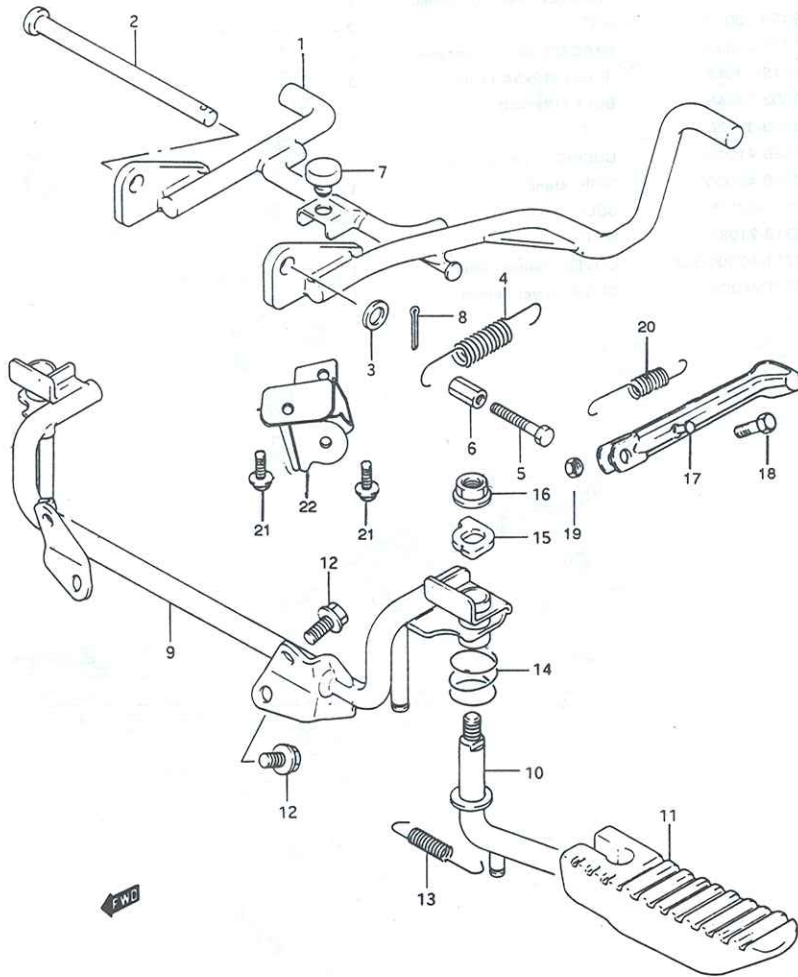

REF. NO.	PART NO.	DESCRIPTION	Q'TY	REMARKS
1	42100M41D00	STAND, center	1	
2	42211-41D00	SHAFT, center stand	1	
3	08322-01103	WASHER	1	
4	09443-15047	SPRING	1	
5	09100-06078	BOLT (6x33)	1	
6	09140-06013	NUT	1	
7	09321M10002	CUSHION	1	
8	04111-25208	COTTER PIN	1	
9	43610M41D00	BAR, pillion footrest	1	
10-1	43620M41D00	ROD, pillion footrest RH	1	
10-2	43630M41D00	ROD, pillion footrest LH	1	
11-1	43642M41D00	RUBBER, pillion footrest RH	1	
11-2	43652M41D00	RUBBER, pillion footrest LH	1	
12	01550-08163	BOLT	4	
13	09443-08052	SPRING	2	
14	09440-19026	SPRING	2	
15-1	43625M41D00	STOPPER, pillion footrest RH	1	
15-2	43635M41D00	STOPPER, pillion footrest LH	1	
16	08319-31106	NUT	2	
17	42310M41D10	STAND COMP, prop	1	
18	42336-06400	BOLT, prop stand	1	
19	08310-00103	NUT, prop stand	1	
20	09443-14026	SPRING, prop stand	1	
21	01570-08163	BOLT, prop stand support	2	
22	42330M40D01	BRKT comp, prop stand	1	

4

FWC

FIG. 24

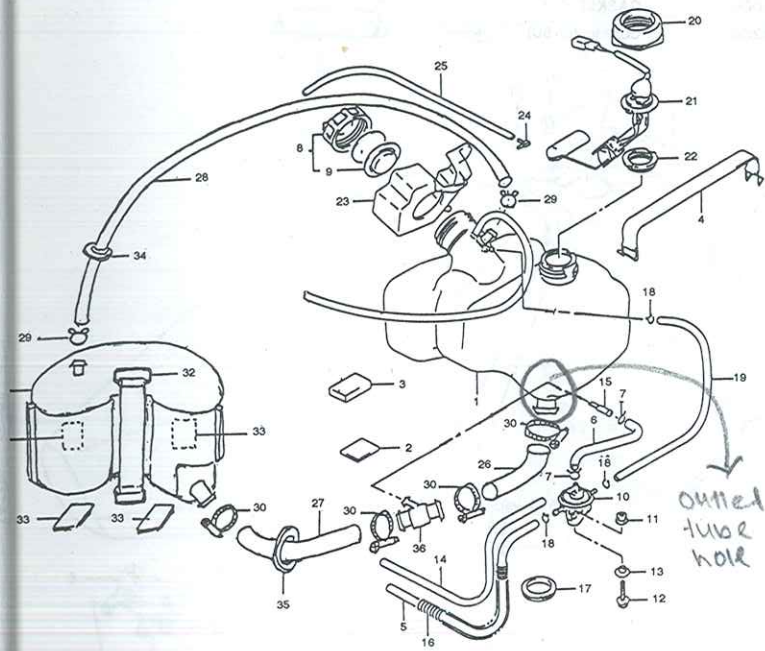

FIG. 24 (E-4) FUEL TANK

REF. NO.	PART NO.	DESCRIPTION	Q'TY	REMARKS
1	44111M40D00	TANK, fuel	1	
2	44281M29C00	CUSHION, fuel tank	5	
3	63411M35B00	CUSHION, fuel tank upper	2	
4	44292M40D00	BAND, fuel tank	1	
5	44424-40D00	HOSE, breather	1	
6	44199-40D00	HOSE, inlet	1	
7-1	09401-10402	CLIP	1	
7-2	09401-11402	CLIP	1	
8	44200-39820	CAP SET, fuel tank	1	
9	44660-36820	.GASKET SET, fuel tank	1	
10	44300-11B01	COCK ASSY, fuel	1	
11	08316-10063	NUT	1	
12	01550-06203	BOLT	1	
13	09169-06032	WASHER	1	
14-1	09352-50823-600	HOSE (L:600 → 270)	1	
14-2	09352-50823-600	HOSE (L:600 → 300)	1	
15	44322-27001	FILTER, fuel	1	
16	09440-10009	SPRING	1	
17	09308M27001	GROMMET	1	
18	09401-08401	CLIP	4	
19	44236-36C10	HOSE, air vent	1	
20	44587-29C00	CAP, fuel level gauge	1	
21	34810-40D00	GAUGE ASSY, fuel level	1	
22	34825-29C00	GASKET	1	
23	44261-40D10	TRAY, fuel drain	1	
24	09367-04005	JOINT	1	
25	09352-40703-600	HOSE (L: 600 → 550)	1	
26	44421-41D90	HOSE, fuel No. 1	1	
27	44422-41D90	HOSE, fuel No. 2	1	
28	44429-41D90	HOSE, breather secondary	1	
29	09401-10401	CLIP, breather hose	2	
30	09402-28511	CLIP, fuel hose	4	
31	49111M41D90	SECONDARY TANK, fuel	1	
32	44293M41D90	BAND, secondary fuel tank	1	
33	33652M35400	CUSHION, secondary fuel tank	4	
34	44461M41D90	GROMMET, 2nd breather hose	1	
35	44462M41D90	GROMMET, fuel hose No. 2	1	
36	44472M41D90	JOINT, fuel tank hose	1	

4

FIG. 25

FIG. 25 (E-5) OIL TANK

REF. NO.	PART NO.	DESCRIPTION	Q'TY	REMARKS
1	44611M40D00	TANK, oil	1	
2	44281M29C00	CUSHION, fuel tank	5	
3	44667-40D00	RUBBER, oil tank inlet	1	
4	44651-39C01	CAP, oil tank filter	1	
5	37880-40D00	SWITCH ASSY, oil level	1	
6	44643-31000	GASKET	1	
7	09404-06206	CLAMP (L: 50)	1	

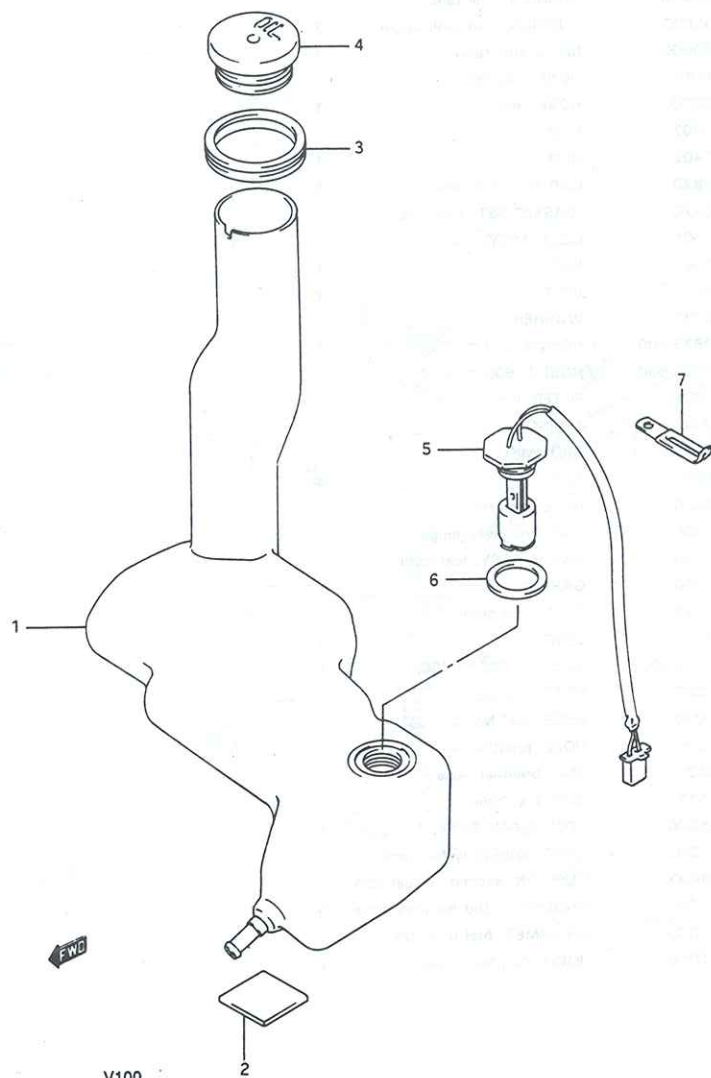

V100

FIG. 26

FIG. 26 (E-6) SEAT

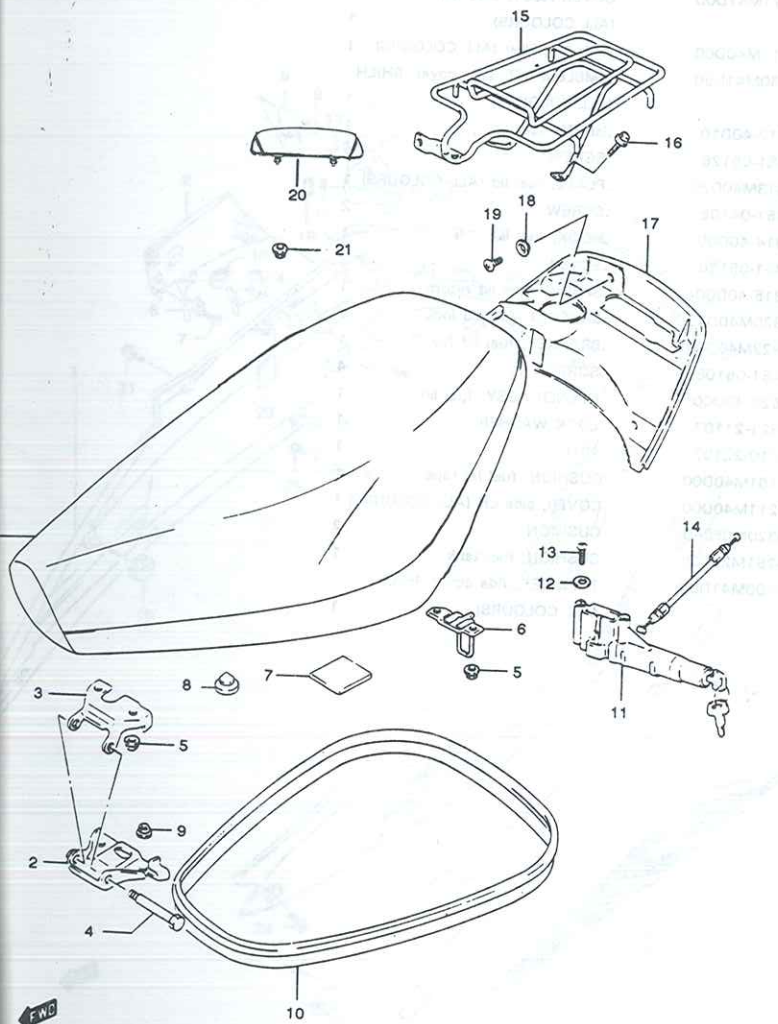

REF. NO.	PART NO.	DESCRIPTION	Q'TY	REMARKS
1	45100M41D01	SEAT SET	1	
2	45260M40D00	.BRACKET, seat front hinge	1	
3	45286M40D00	.BRACKET, seat front	1	
4	45215-39C01	.BOLT	1	
5	08316-20063	.NUT	4	
6	45210M40D00	.STRIKER, seat lock	1	
7	45226M39C00	.CUSHION	1	
8	45148M36C00	.CUSHION	1	
9	08316-20063	NUT	2	
10	45211-40D00	MOLDING, seat	1	
11	45700-40811	LOCKET SET, seat	1	
12	09160-06502	WASHER, RH	1	
13	02112-36163	SCREW	2	
14	45280M35400	CABLE, seat lock	1	
15	46410M41D00	CARRIER, rear	1	
16	01550-06203	BOLT	2	
17	47341M40D01	COVER, upper	1	
18	09169-06034	WASHER	1	
19	02142-06123	SCREW	3	
20	46450M41D00	EXTENSION SEAT	1	
21	08316-20063	NUT	2	

4

V100

FIG. 27

FIG. 27 (E-7) FRAME COVER

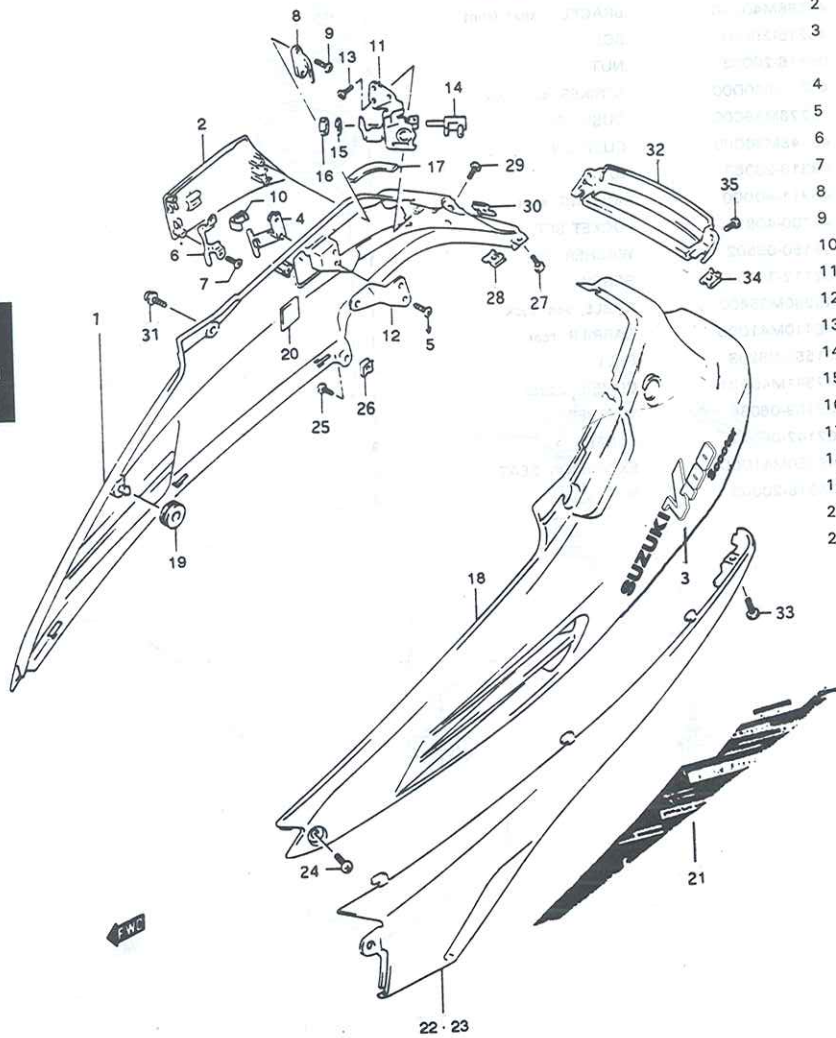

REF. NO.	PART NO.	DESCRIPTION	Q'TY	REMARKS
1	47111M41D00	COVER ASSY, side RH (ALL COLOURS)	1	
2	47311M40D00	.LID, fuel filter (ALL COLOURS)	1	
3	68130M41D50	.EMBLEM SET, side cover, RH/LH (ALL COLOURS)	1	
4	47312-40D10	.HINGE, fuel lid	1	
5	03451-05126	.SCREW	2	
6	47313M40D20	.PLATE, fuel lid (ALL COLOURS)	1	
7	03451-04108	.SCREW	2	
8	47314-40D00	.HOOK, fuel lid	1	
9	03451-05126	.SCREW	2	
10	47315-40D00	.SPRING, fuel lid return	1	
11	47920M40D00	.BRACKET, fuel lid lock	1	
12	47922M40D00	.BRACKET, fuel lid No. 2	1	
13	03451-05108	.SCREW	4	
14	76520-40D00	.OPENER ASSY, fuel lid	1	
15	08321-21107	.LOCK WASHER	1	
16	08310-22107	.NUT	1	
17	47161M40D00	CUSHION, fuel lid tape	1	
18	47211M40D00	COVER, side LH (ALL COLOURS)	1	
19	09320M08049	CUSHION	2	
20	44281M29C00	CUSHION, fuel tank	1	
21	68100M41D50	TAPE SET, side cover RH/LH (ALL COLOURS)	1	

FIG. 27

FIG. 27 (E-8) FRAME COVER

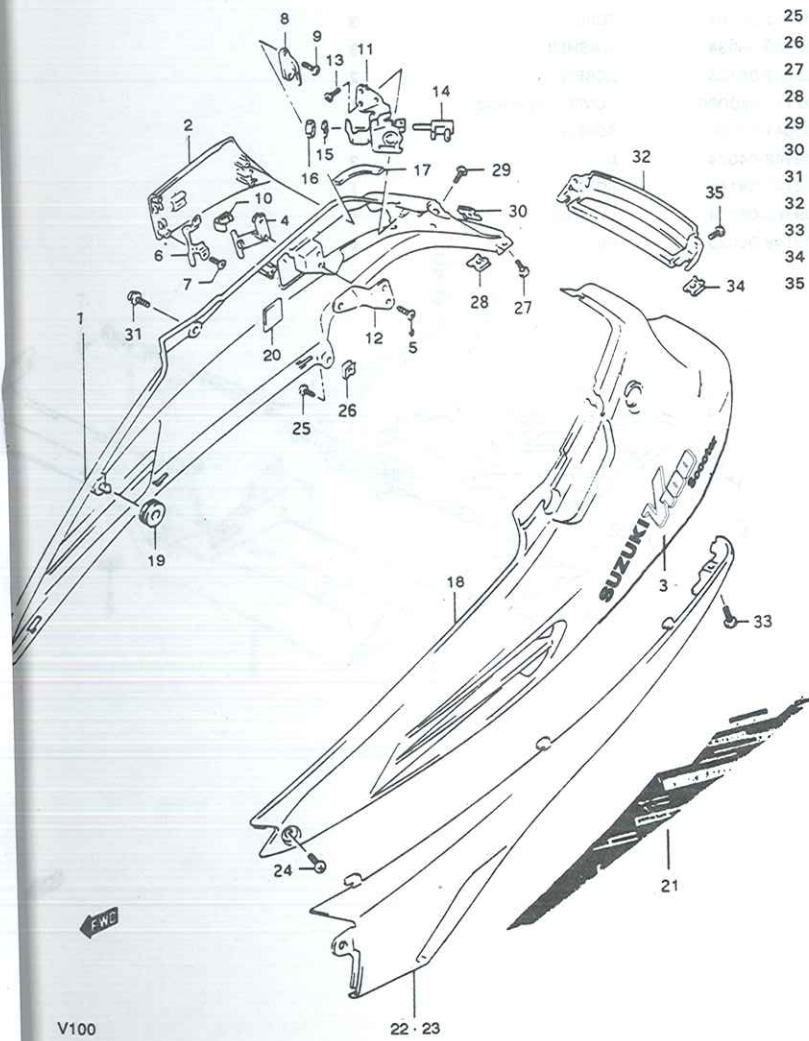

REF. NO.	PART NO.	DESCRIPTION	Q'TY	REMARKS
22	47131M41D00	COVER, side lower RH	1	
23	47231M41D00	COVER, side lower LH	1	
24	02142-15125	SCREW	2	
25	03242-05163	SCREW	2	
26	09148-05020	NUT	2	
27	03541-04125	SCREW	1	
28	09148-04024	NUT	1	
29	03241-15165	SCREW	1	
30	09148-05004	NUT	1	
31	02142-16125	SCREW	1	
32	47321M40D00	COVER, rear	1	
33	03241-05163	SCREW	2	
34	09148-05020	NUT	2	
35	03242-05129	SCREW	2	

4

V100

30

FIG. 28

FIG. 28 (E-9) LEG SHIELD

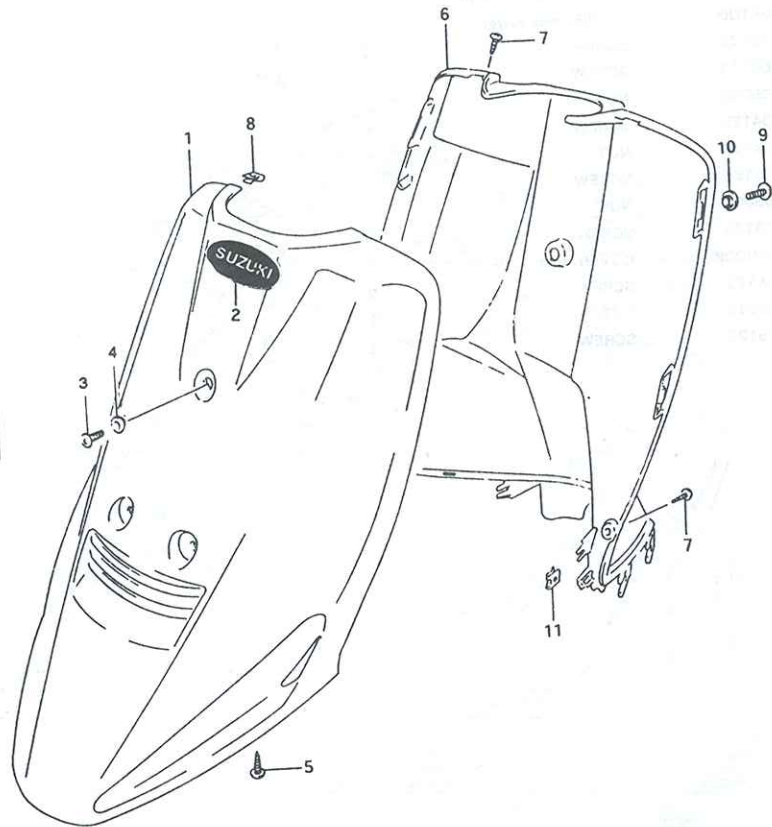

REF. NO.	PART NO.	DESCRIPTION	Q'TY	REMARKS
1	48111M40D00	SHIELD, leg front (ALL COLOURS)	1	
2	68161M41D00	EMBLEM, leg shield	1	
3	02142-06164	SCREW	3	
4	09169-06034	WASHER	3	
5	03242-05163	SCREW	2	
6	92111M40D00	COVER, leg shield	1	
7	03541-04165	SCREW	4	
8	09148-04024	NUT	2	
9	02142-06164	SCREW	1	
10	09169-06034	WASHER	1	
11	09148-05020	NUT	6	

FIG. 29

FIG. 29 (E-10) REAR LEG SHIELD

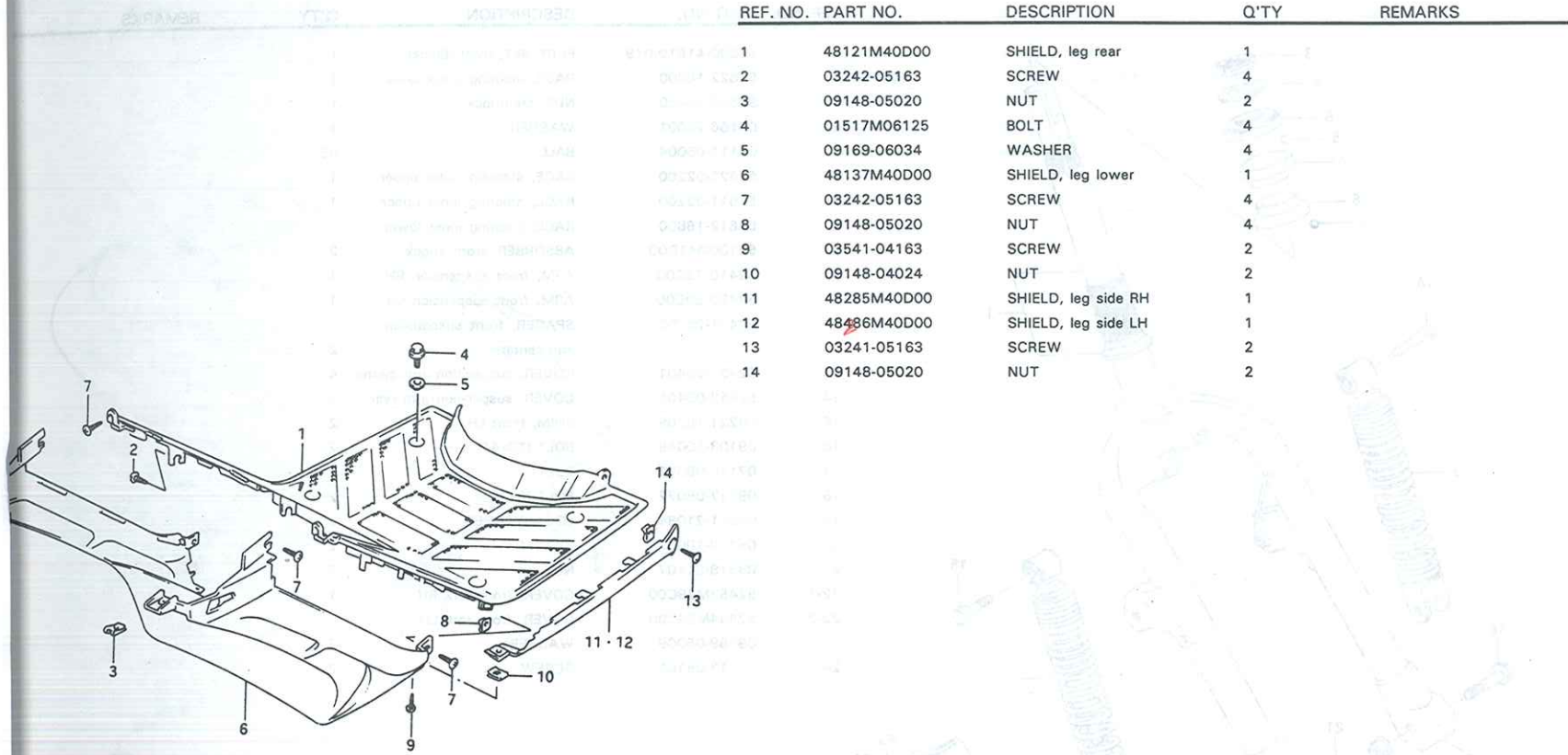

REF. NO.	PART NO.	DESCRIPTION	Q'TY	REMARKS
1	48121M40D00	SHIELD, leg rear	1	
2	03242-05163	SCREW	4	
3	09148-05020	NUT	2	
4	01517M06125	BOLT	4	
5	09169-06034	WASHER	4	
6	48137M40D00	SHIELD, leg lower	1	
7	03242-05163	SCREW	4	
8	09148-05020	NUT	4	
9	03541-04163	SCREW	2	
10	09148-04024	NUT	2	
11	48285M40D00	SHIELD, leg side RH	1	
12	48486M40D00	SHIELD, leg side LH	1	
13	03241-05163	SCREW	2	
14	09148-05020	NUT	2	

4

FIG. 30

FIG. 30 (F-2) FRONT FORK

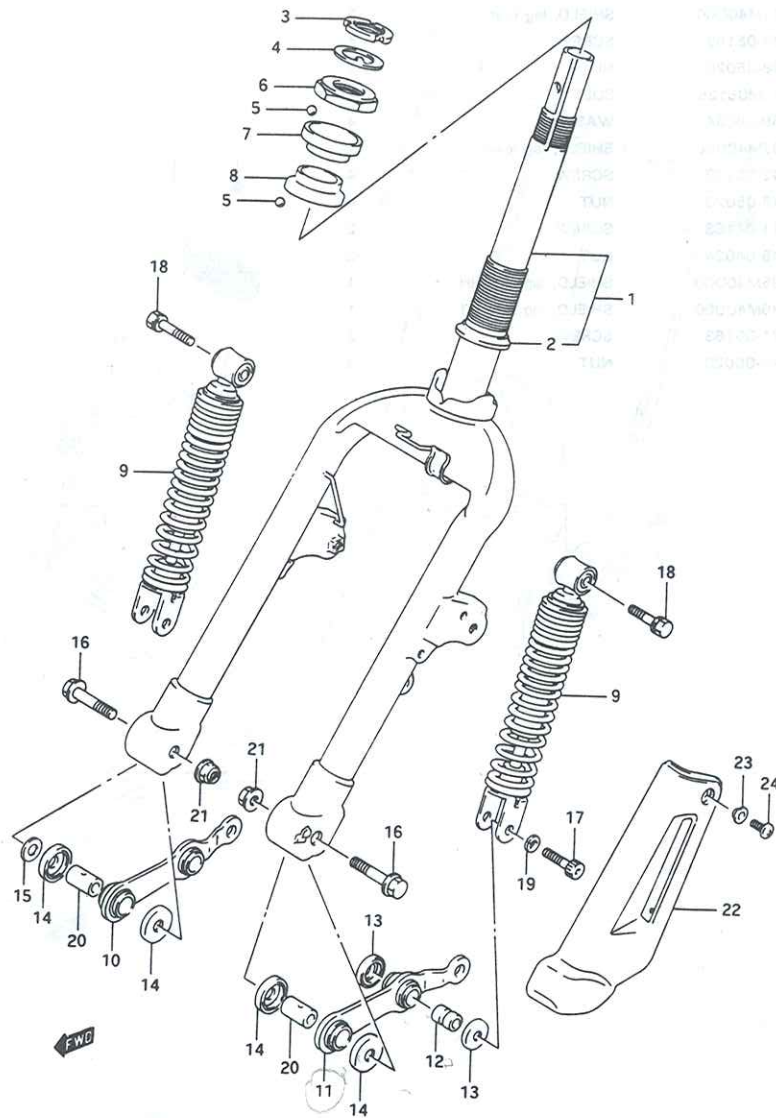

V100

REF. NO.	PART NO.	DESCRIPTION	Q'TY	REMARKS
1	51200-41810-019	FORK SET, front (Black)	1	
2	51622-16B00	RACE, steering outer lower	1	
3	99800-10420	NUT, stem lock	1	
4	09166-26001	WASHER	1	
5	06111-05004	BALL	55	
6	51621-02200	RACE, steering outer upper	1	
7	51611-02200	RACE, steering inner upper	1	
8	51612-16B00	RACE, steering inner lower	1	
9	52100M41D00	ABSORBER, front shock	2	
10	52410-29C00	ARM, front suspension RH	1	
11	52430-29C00	ARM, front suspension LH	1	
12	52431-25E00	SPACER, front suspension arm center	2	
13	52451-09401	COVER, suspension arm center	4	
14	52452-09401	COVER, suspension arm rear	4	
15	08221-10205	SHIM, front LH	2	
16	09103-10049	BOLT (10x44)	2	
17	07110-08355	BOLT	2	
18	09117-08072	BOLT (8x35)	2	
19	08321-21084	LOCK WASHER	2	
20	09319-10002	SPACER	2	
21	08319-31107	NUT	2	
22-1	52453M29C00	COVER, front fork RH	1	
22-2	52454M29C00	COVER, front fork LH	1	
23	09169-05009	WASHER	2	
24	02112-05105	SCREW	2	

FIG. 31

FIG. 31 (F-3) FRONT FENDER

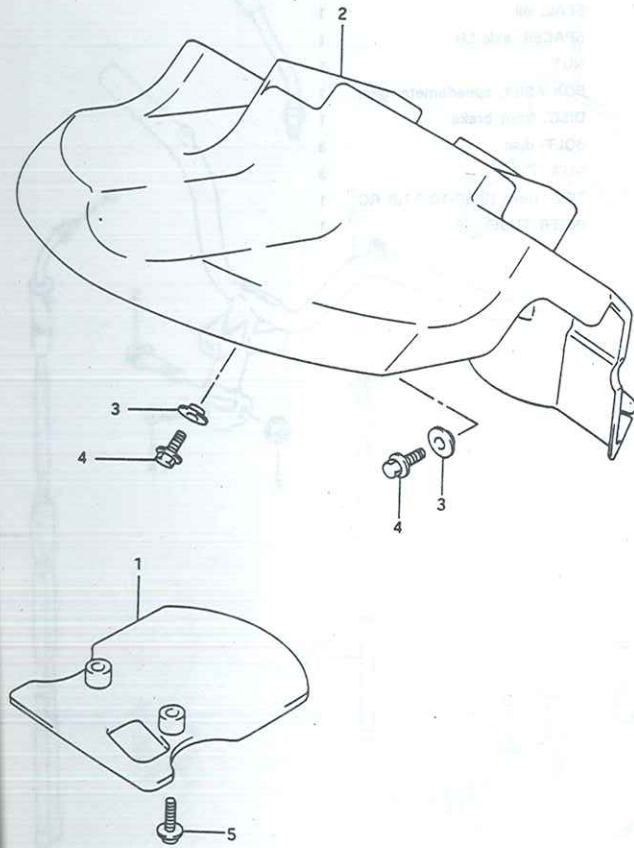

REF. NO.	PART NO.	DESCRIPTION	Q'TY	REMARKS
1	53181M29C02	FENDER, movable front	1	
2	53182M40D01	FENDER, fixed front	1	
3	09169-06032	WASHER	2	
4	01514M06126	BOLT	2	
5	02142-05163	SCREW	2	

4

FIG. 32

FIG. 32 (F-4) FRONT WHEEL

REF. NO.	PART NO.	DESCRIPTION	Q'TY	REMARKS
1	54140-41D00	WHEEL, front (2.15x10)	1	
2	08123-62007	BEARING (10x30x9)	2	
3	54730-41D00	SPACER, wheel bearing	1	
4	54711-41D00	AXLE, front	1	
5	09285-16002	SEAL, oil	1	
6	54741M29C00	SPACER, axle LH	1	
7	08319-31107	NUT	1	
8	54600-28B00	BOX ASSY, speedometer gear	1	
9	59211-29C10	DISC, front brake	1	
10	59421-03A10	BOLT, disc	3	
11	08319-21088	NUT	3	
12	55100M41D10	TIRE, front (3.50-10 51J) RC	1	
13	55220M41D10	INNER TUBE	1	

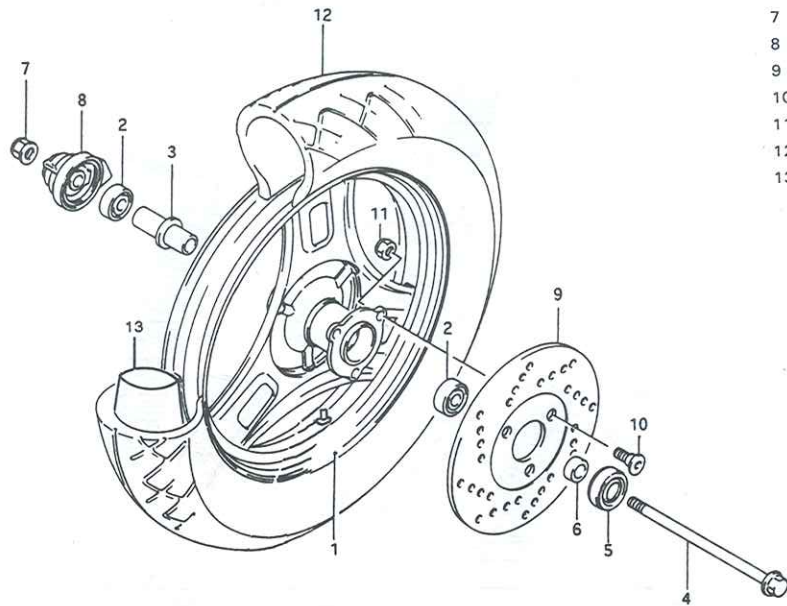

4

FWC

FIG. 33

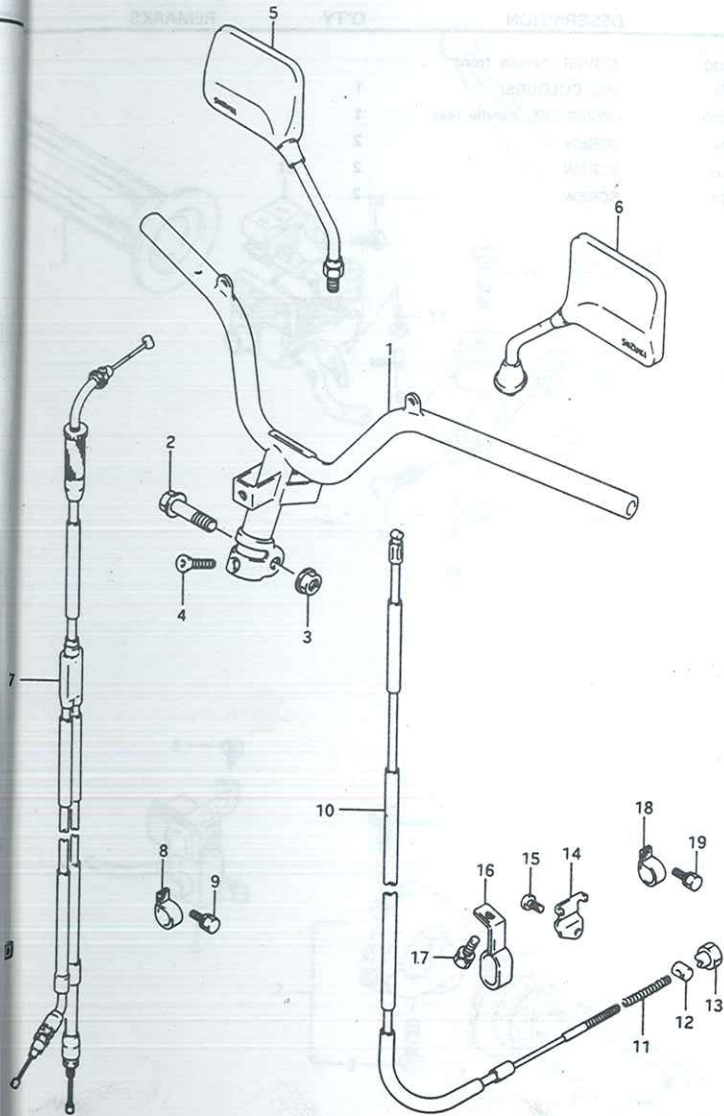

V100

FIG. 33 (F-5) HANDLE BAR

REF. NO.	PART NO.	DESCRIPTION	Q'TY	REMARKS
1	56110M41D01	HANDLE BAR	1	
2	09103-10116	BOLT (10x43)	1	
3	08319-31106	NUT	1	
4	56123-29C00	SCREW (8x35)	1	
5	56500M39C10	MIRROR ASSY, rear view RH	1	
6	56600M39C00	MIRROR ASSY, rear view LH	1	
7	58300M41D01	CABLE ASSY, throttle	1	
8	09403-19407	CLAMP	1	
9	02112-06123	SCREW	1	
10	58510M41D00	CABLE, rear brake	1	
11	09440-07062	SPRING	1	
12	09209-10001	PIN	1	
13	09150-05101	NUT	1	
14	58575M37B00	PLATE, rear brake cable	1	
15	02112-06103	SCREW	1	
16	09403-16409	CLAMP	1	
17	01570-08163	BOLT	1	
18	09403-14004	CLAMP	1	
19	01570-06163	BOLT	1	

4

FIG. 34

FIG. 34 (F-6) HANDLE COVER

REF. NO.	PART NO.	DESCRIPTION	Q'TY	REMARKS
1	56311M41D00	.COVER, handle front (ALL COLOURS)	1	
2	56321M40D00	COVER SET, handle rear	1	
3	02142-05124	SCREW	2	
4	03511-05166	SCREW	2	
5	03541-04165	SCREW	2	

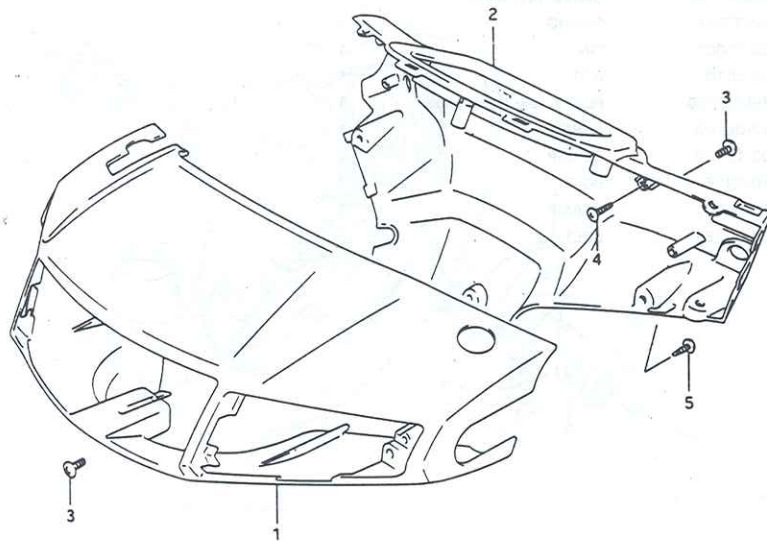

FWB

FIG. 35

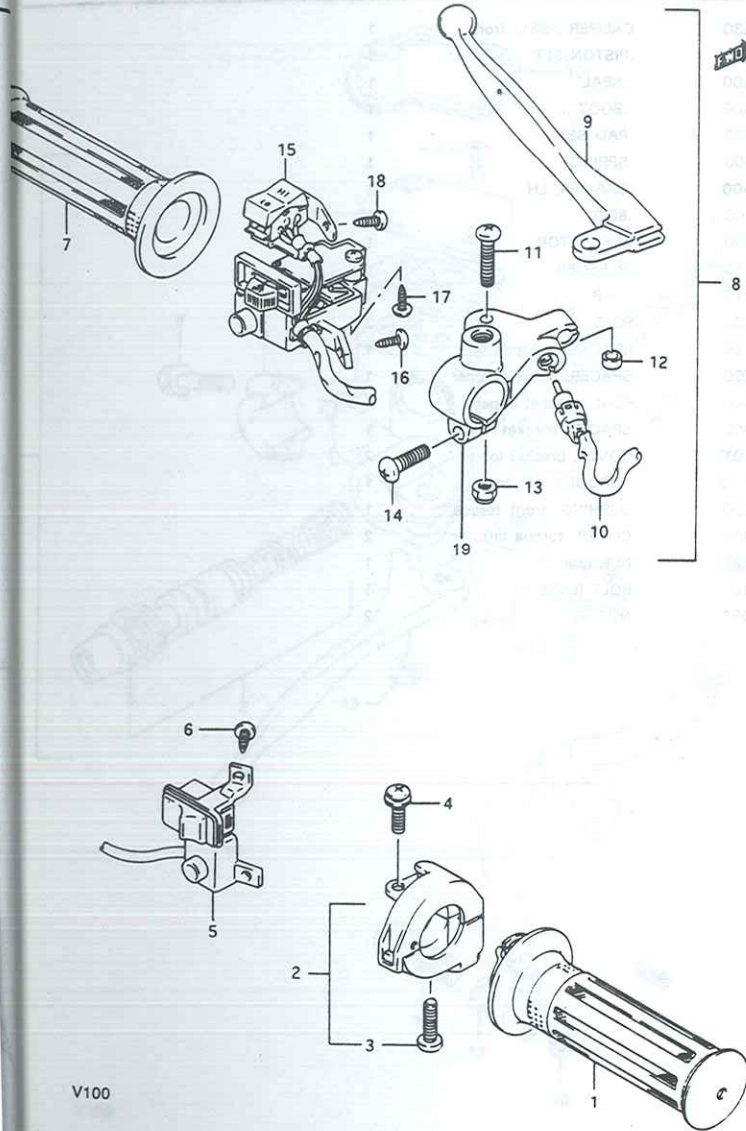

FIG. 35 (F-7) HANDLE SWITCH

REF. NO.	PART NO.	DESCRIPTION	Q'TY	REMARKS
1	57110M11B00	GRIP, throttle	1	
2	57100-29C02	CSE ASSY, throttle	1	
3	02112-05207	.SCREW	1	
4	09136-05040	SCREW	1	
5	37200-41D00	SWITCH ASSY, handle RH	1	
6	03451-04123	SCREW	2	
7	57211M11B00	GRIP, LH	1	
8	57500-29C01	BRAKE LEVER REAR/SWITCH ASSY	1	
9	57621M02420	.LEVER, brake	1	
10	57460-02500	.SWITCH, brake	1	
11	02112-05257	.SCREW	1	
12	57435-12900	.SPACER	1	
13	08319-21057	.NUT	1	
14	02112-06207	.SCREW	1	
15	37400-41D00	SWITCH ASSY, handle LH	1	
16	03541-04123	SCREW	1	
17	03541-04125	SCREW	1	
18	03511-04123	SCREW	1	
19	57511M36C00	HOLDER LEVEL	1	

57421M03A(1-000 brake lever RH

4

FIG. 36

FIG. 36 (F-8) FRONT CALIPER

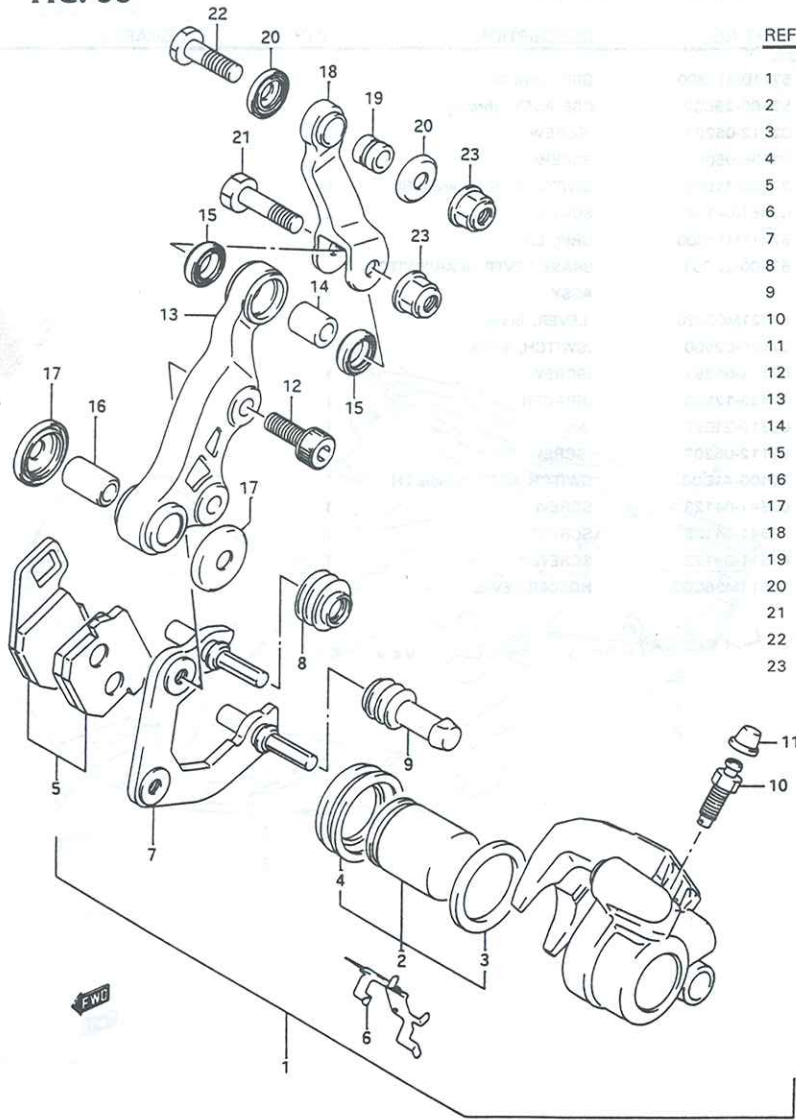

REF. NO.	PART NO.	DESCRIPTION	Q'TY	REMARKS
1	59300-03A30	CALIPER ASSY, front	1	
2	59300-03810	.PISTON SET	1	
3	59107-03A00	..SEAL	1	
4	59308-03A00	..BOOT	1	
5	59300-03860	.PAD SET	1	
6	59315-36500	.SPRING	1	
7	59350-03A00	.CARRIER, LH	1	
8	59312-36500	.BOOT	1	
9	59313-36500	.INSULATOR	1	
10	59121-18410	.BLEEDER	1	
11	55156-66310	.CAP	1	
12	07120-08205	BOLT	2	
13	59720-29C00	BRACKET, caliper	1	
14	64336-25E00	SPACER, bracket upper	1	
15	62647-04A00	SEAL, bracket upper	2	
16	09319-10002	SPACER, bracket lower	1	
17	52452-09401	COVER, bracket lower	2	
18	54311-29C00	TORQUE LINK, front	1	
19	54341-25E00	BUSHING, front torque	1	
20	54342-16B00	COVER, torque link	2	
21	09100-08223	BLT, rear	1	
22	09100-08260	BOLT (L:30)	1	
23	08319-31087	NUT	2	

FIG. 37

FIG. 37 (F-9) FRONT MASTER CYLINDER

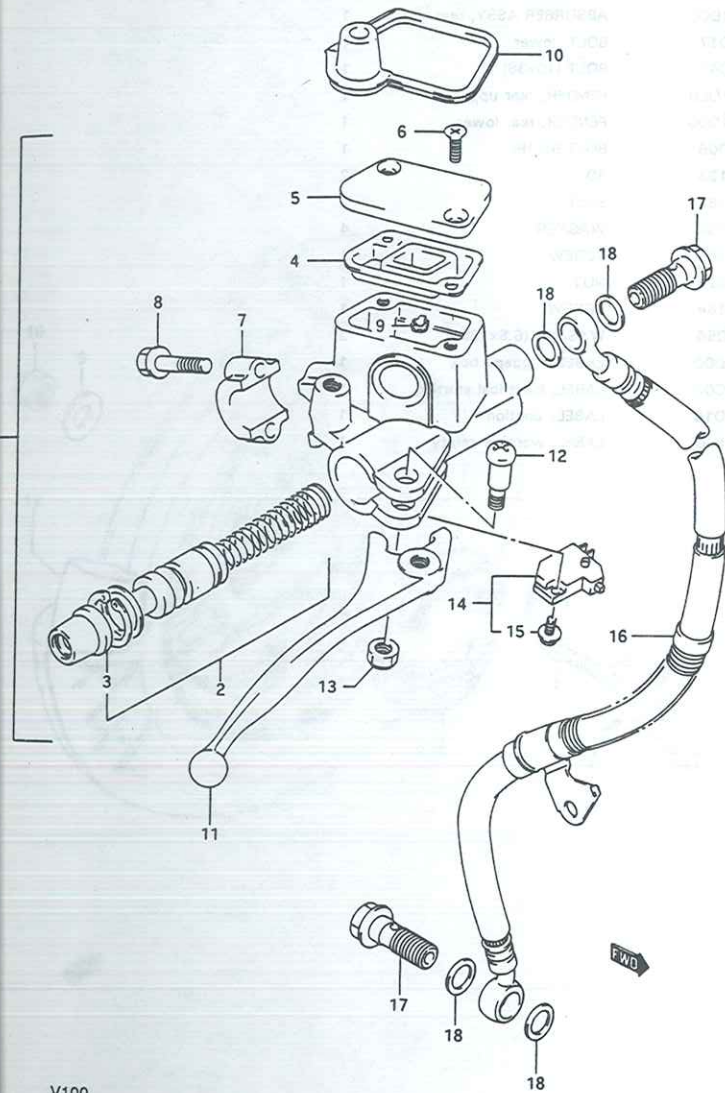

REF. NO.	PART NO.	DESCRIPTION	Q'TY	REMARKS
1	59600-36C00	CYLINDER ASSY, front matter	1	
2	59600-03810	.PISTON/CUP SET	1	
3	59666-44300	..BOOT	1	
4	59667-03A00	.DIAPHRAGM	1	
5	59669-36C00	.CAP	1	
6	69689-49300	.SCREW	2	
7	59671-29C00	.HOLDER	1	
8	01550-06253	.BOLT	2	
9	59664-48B00	.PROTECTOR	1	
10	59711-29C00	COVER, master cylinder	1	
11	57421M03A11	LEVER, brake	1	
12	57431-29C00	SCREW, lever	1	
13	08319-21068	NUT	1	
14	57460-17C00	SWITCH ASSY, stop	1	
15	57465-17C00	SCREW	1	
16	59480-41D00	HOSE, front brake	1	
17	09360-10017	UNION BOLT (10x1.02x24)	2	
18	09161-10009	WASHER (10x15x1.5)	4	

V100

FIG. 38

FIG. 38 (F-10) REAR FENDER / LABEL

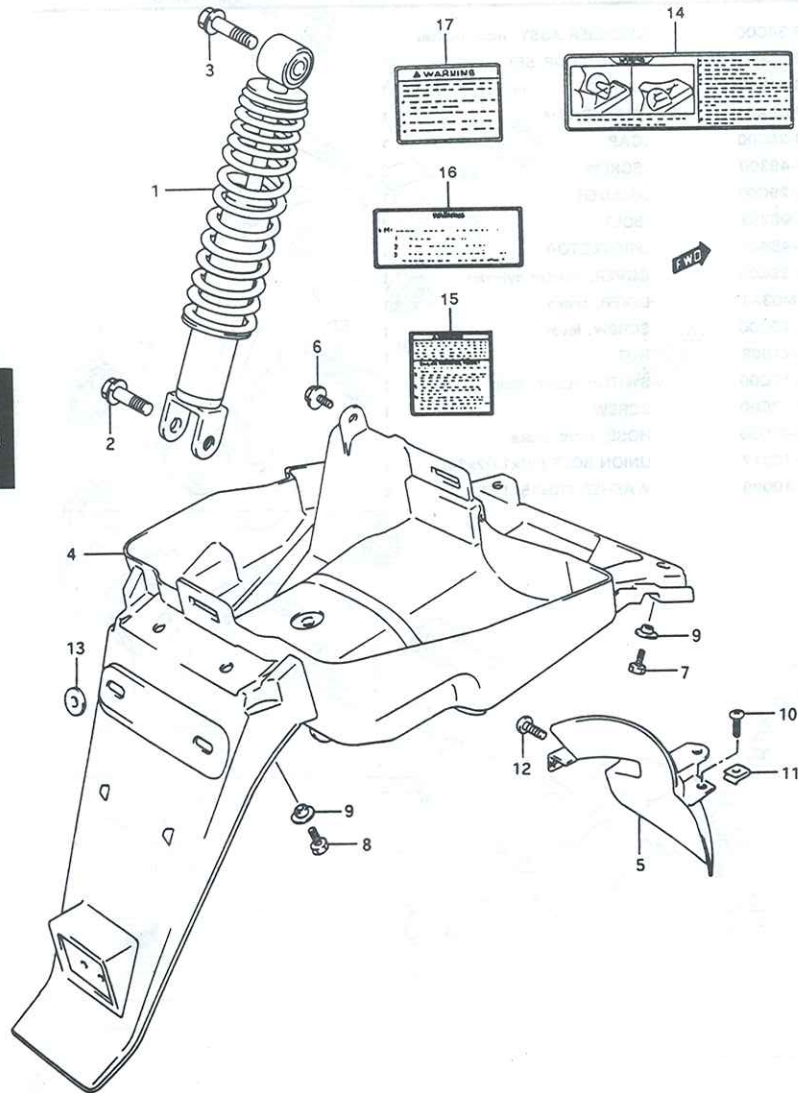

REF. NO.	PART NO.	DESCRIPTION	Q'TY	REMARKS
1	62100M41D00	ABSORBER ASSY, rear shock	1	
2	09117-10017	BOLT, lower	1	
3	09117-10041	BOLT (10x38)	1	
4	63111M41D00	FENDER, rear upper	1	
5	63112M41D00	FENDER, rear lower	1	
6	09116-06006	BOLT (6x16)	1	
7	01500-06123	BOLT	2	
8	01500-06163	BOLT	2	
9	09169-06032	WASHER	4	
10	03541-04168	SCREW	1	
11	09148-04024	NUT	1	
12	02142-06164	SCREW	1	
13	09160-06056	WASHER (6.5x18x1)	2	
14	68611-41D00	LABEL, luggage box	1	
15	68343-36C00	LABEL, Electrical starting	1	
16	68319-41D10	LABEL, caution	1	
17	68319-33E00	LABEL, warning safety	1	

4

FIG. 39

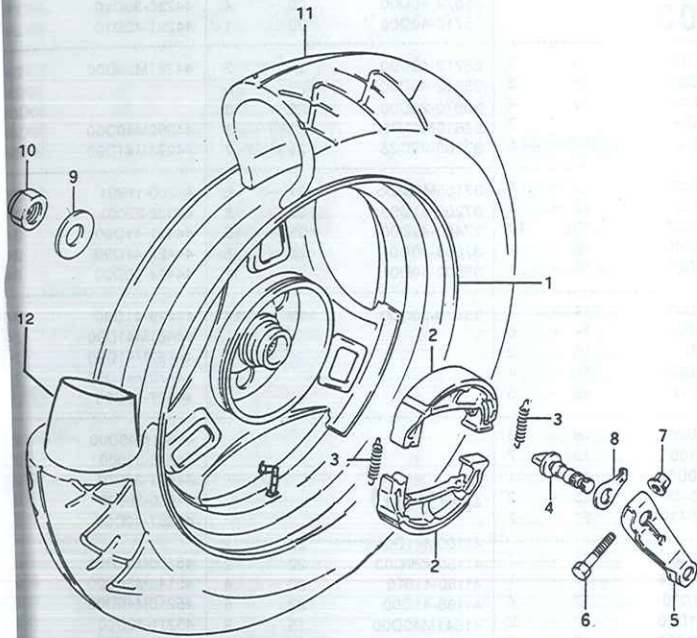

FIG. 39 (F-11) REAR WHEEL

REF. NO.	PART NO.	DESCRIPTION	Q'TY	REMARKS
1	64140-41D00	WHEEL, rear (2.15-10)	1	
2	64410-41D00	SHOE, brake	2	
3	09443-07001	SPRING	2	
4	64441-41D00	CAM, rear brake	1	
5	64451-02111	LEVEL, rear brake cam	1	
6	09100-06139	BOLT	1	
7	09159-06017	NUT	1	
8	64492-17B01	PLATE, indicator	1	
9	09160-16039	WASHER	1	
10	08319-21168	NUT	1	
11	55100M41D10	TIRE, rear (3.50-10 51J) RC	1	
12	55220M41D10	TUBE INNER	1	

4

PART NO.	FIG. NO. REF. NO.	PART NO.	FIG. NO. REF. NO.	PART NO.	FIG. NO. REF. NO.
10000		13278-29C50	5 - 37	17110M04C00	9 - 1
		13278-39C60	5 - 18	17121M41D00	9 - 4
		13291-35010	5 - 34	17131M41D00	9 - 3
		13295-33010	5 - 35	17145M41D00	9 - 8
		13370-02421	5 - 11	17150-41D01	9 - 5
11111M41D00	1 - 1	13373-46710	5 - 19	17170M41D10	3 - 9
11141M04C00	1 - 2	13383-41D00	5 - 6	17174-41D00	3 - 10
11210M41D00-0F0	1 - 5	13394-40D00	5 - 5	17175-41D01	3 - 15
11241M41D20	1 - 6	13401-41D00	5 - 1	17181M41D00	3 - 11
11310M41D00	2 - 1	13484-29C50	5 - 30	17190M41D00	3 - 13
11327-41D00	3 - 8	13511-29C50	5 - 4	20000	
11340-41810	3 - 1	13540-25E00	5 - 22		
11380-37811	2 - 21	13543-09400	5 - 21		
11393-20E00	2 - 15	13550-29C50	5 - 24		
11401-41844	1 - 10	13551-40D00	5 - 7		
11411M41D01	8 - 17	13557-09400	5 - 25	21110-41D00	10 - 1
11431-41D00	2 - 10	13569-29C50	5 - 29	21120-04C03	10 - 2
11482M41D00	3 - 2	13573-25E10	5 - 28	21122-37B01	10 - 7
11484-41D00	2 - 11	13574-29C50	5 - 26	21210-04C10	11A - 2
12105-04820	4 - 20	13601-04228	5 - 3	21210-41D00	11 - 2
12110M41D00-0F0	4 - 1	13601-05148	5 - 15	21213-41D00	11 - 13
12110M41D00-050	4 - 1	13650-25E01	5 - 42	21220-04C11	11 - 15
12110M41D00-100	4 - 1	13651-51010	5 - 27	21220-04C20	11A - 13
12140-35510	4 - 2	13684-29C50	5 - 39	21240-41D00	11 - 9
12140-35510-050	4 - 2	13700-41D00	6 - 1	21240-41D20	11A - 8
12140-35510-100	4 - 2	13735M29C51	6 - 13	21431-41D01	10 - 4
12151-35500	4 - 3	13740-41D00	6 - 6	21471-03A02	11 - 12
12161-04C00	4 - 7	13749-41D00	6 - 4	21471-03A03	11A - 11
12200-41D00	4 - 6	13780M41D10	6 - 2	21481-41D02	10 - 5
12211-04C00	4 - 8	13789-29C52	6 - 14	21501-41D41	11A - 14
12221-41D00	4 - 9	13791-41D00	6 - 3	21501-41D00	11 - 16
12261-41D00	4 - 10	13821-39C00	6 - 5	21650-41D12	10 - 6
12622-04C00	4 - 17	13878-39C10	6 - 10	24131-04C01	11A - 1
13111-41D02	2 - 27	13881-29C50	6 - 8	24131-41D00	11 - 1
13125M41D00	2 - 28	14181M41D00	7 - 1	24141-41D00	11 - 28
13150-41D10	2 - 31	14186-41D00	7 - 8	24141-41D00	11A - 25
13200-41D02	5	14310-41D00	7 - 3	24150-41D00	11 - 19
13237-29C50	5 - 31	14773M41D00	7 - 7	24150-41D20	11A - 17
13247-25E00	5 - 16	14780-29C22-291	7 - 11	24371-41D00	11 - 29
13250-29C50	5 - 12	16100-41D04	8 - 1		11A - 26
13254-29C50	5 - 13	16331-37B00	8 - 20	24751-07900	11 - 34
13258-29C50	5 - 14	16630-41D02	8 - 5		11A - 31
13267-25E00	5 - 36	16731-41D00	8 - 2	26210-41D00	12 - 1
13268-35010	5 - 33	16910-09C00	2 - 34	26280-41D01	10 - 12
13278-02340	5 - 17	16910-21D00	2 - 35	26282-41D00	10 - 13

PART NO.	FIG. NO. REF. NO.	PART NO.	FIG. NO. REF. NO.	PART NO.	FIG. NO. REF. NO.
26283-41D02	10 - 15	35601-40D00	19 - 1	43630M41D00	23 - 10
26284-41D00	10 - 16	35602-40D00	19 - 2	43635M41D00	23 - 15
26300M41D11	12 - 4	35612-40D00	19 - 3	43642M41D00	23 - 11
27601-04C03	10 - 11	35614-40D00	19 - 5	43652M41D00	23 - 11
		35618-40D00	19 - 8	43980-40D00	22 - 9
		35632-40D00	19 - 4	44111M40D00	24 - 1
		35638-40D00	19 - 9	44199-40D00	24 - 6
		35652-40D00	20 - 3	44200-39820	24 - 8
		35672-40D00	20 - 4	44236-36C10	24 - 19
		35710-40D00	20 - 1	44261-40D10	24 - 23
30000					
31100-41D00	13 - 1	35712-40D00	20 - 2	44281M29C00	24 - 2
31130-04C00	13 - 3	35912-40D00	20 - 5		25 - 2
31135-05B00	13 - 4	35970-29C00	20 - 10		27 - 20
31142-41D00	13 - 7	36610M41D00	21 - 1	44292M40D00	24 - 4
31157-02540	13 - 5	37100-29C23	21 - 7	44293M41D90	24 - 32
31156-05B00	13 - 9	37155M29855	21 - 6	44300-11B01	24 - 10
31311-04C01	13 - 2	37200-41D00	35 - 8	44322-27001	24 - 15
31370-41D00	13 - 10	37400-41D00	35 - 15	44421-41D90	24 - 26
31800-19D00	16 - 1	37880-40D01	25 - 5	44422-41D90	24 - 27
32101-41D01	14 - 1	38500-40D01	21 - 11	44424-40D00	24 - 5
32102-41D01	14 - 2	38610-36C00	19 - 12	44429-41D90	24 - 28
32371-41D00	14 - 6			44461M41D90	24 - 34
32800-40D10	16 - 2			44462M41D90	24 - 35
33410-41D00	16 - 4			44472M41D90	24 - 36
33510-35411	16 - 5			44587-29C00	24 - 20
33542-38B00	16 - 6			44611M40D00	25 - 1
33543-02100	16 - 7			44643-31000	25 - 6
33610M40D50	15 - 1			44651-39C01	25 - 4
33652M35400	15 - 2			44660-36820	24 - 9
33652M38A10	21 - 2			44667-40D00	25 - 3
33652M35400	24 - 33	41100M41D01	22 - 1	45100M41D01	26 - 1
34100M41D24	17 - 1	41150M29C03	22 - 2	45148M36C00	26 - 8
34111M41D00	17 - 4	41180-41810	22 - 4	45210M40D00	26 - 6
34120M41D20	17 - 2	41185-41D00	22 - 8	45211-40D00	26 - 10
34150M40D00	17 - 3	41541M40D00	15 - 3	45215-39C01	26 - 4
34173-41D00	17 - 5	41542M40D00	15 - 6	45226M39C00	26 - 7
34383-09400	17 - 7	41545M40D00	15 - 7	45260M40D00	26 - 2
34810-40D00	24 - 21	42100M41D00	23 - 1	45280M35400	26 - 14
34825-29C00	24 - 22	42211-41D00	23 - 2	45286M40D00	26 - 3
34910M41D00	17 - 11	42310M41D10	23 - 17	45700-40811	26 - 11
35100-40D01	18 - 1	42330M40D01	23 - 22	46410M41D00	26 - 15
35121-39C00	18 - 2	42336-06400	23 - 18	46450M41D00	26 - 20
35124-39C00	18 - 3	43610M41D00	23 - 9	47111M41D00	27 - 1
35171-16A00	18 - 5	43620M41D00	23 - 10	47131M41D00	27 - 22
35194-39C00	18 - 6	43625M41D00	23 - 15	47161M40D00	27 - 17

5

PART NO.	FIG. NO. REF. NO.	PART NO.	FIG. NO. REF. NO.	PART NO.	FIG. NO. REF. NO.	PART NO.	FIG. NO. REF. NO.	PART NO.	FIG. NO. REF. NO.	PART NO.	FIG. NO. REF. NO.
08221-10205	30 - 15	09100-12028	2 - 25	09160-16039	39 - 9	09262-15017	11 - 25		24 - 14	09471-12171	18 -
08310-00053	20 - 12	09103-10049	30 - 16	09160-20010	4 - 12		11A - 22	09359-45852-600	8 - 7	09482-00244-111	1 -
08310-00127	2 - 26	09103-10116	33 - 2	09161-10009	37 - 18	09262-15028	11 - 5	09359-45854-600	8 - 7	09482M00105	1 -
08310-00103	23 - 19	09103-12045	22 - 6	09166-26001	30 - 4	09262-20130	11 - 26	09360-10017	37 - 17	09491-60010	5 -
08310-22107	27 - 16	09108-08056	1 - 8	09168-06001	5 - 44	09262-25070-0A0	4 - 14	09367-03001	8 - 13	09491-62007	5 -
08310-62047	11 - 32	09108-08216	1 - 9	09168-06004	2 - 20	09263-12023	4 - 5	09367-04005	24 - 24	09492-22010	5 -
08313-21087	22 - 11	09116-06006	38 - 6	09168-07001	3 - 7	09263-16012	11 - 21	09381-12001	4 - 4	09493-22005	5 -
08316-10063	20 - 9	09117-08072	30 - 18	09168-08008	2 - 18		11A - 19	09401-04401	8 - 14	09494-00728	5 -
	24 - 11	09117-10017	38 - 2	09169-05009	30 - 23	09263-17042	11 - 7	09401-08401	8 - 15		
08316-10083	1 - 3	09117-10041	38 - 3	09169-06021	9 - 9		11A - 7		24 - 18		
08316-10087	1 - 3	09125-06081	14 - 3	09169-06031	15 - 9	09263-20068	4 - 11	09401-09101	8 - 9		
08316-10103	11A - 16	09128-05012	8 - 19	09169-06032	24 - 13	09280-20003	8 - 2A	09401-10401	24 - 29		
08316-16108	11 - 18	09128-05101	18 - 7		31 - 3	09280-41005	11 - 11	09401-10402	24 - 7		
	14 - 4	09128-06071	2 - 33		38 - 9		11A - 10	09401-11402	24 - 7		
08316-20063	21 - 10	09132-03012	19 - 10	09169-06034	26 - 18	09280-85003	10 - 8	09401-31403	3 - 16		
	26 - 5	09136-05040	35 - 4		28 - 4	09283-17017	4 - 15	09402-42306	6 - 9		
	26 - 9	09136-06100	21 - 12		28 - 10	09283-17023	11A - 24	09402-28511	24 - 30		
	26 - 21	09136-06100	9 - 2		29 - 5	09283-20052	11 - 27	09403-14004	33 - 18		
08319-21057	35 - 13	09137-06021	6 - 11	09180-05025	8 - 18	09283-25083	4 - 16	09403-16409	33 - 16		
08319-21068	37 - 13	09138-04005	2 - 32	09180-05042	11 - 4	09283-27010	11A - 28	09403-19407	33 - 8		
08319-21088	32 - 11	09138-06045	9 - 6		11A - 4	09283-27014	11 - 31	09404-06206	25 - 7		
08319-21168	39 - 10	09139-06014	21 - 9	09180-06242	3 - 6	09283-34007	11 - 10	09404-06402	5 - 43		
08319-31065	3 - 14	09139-06077	15 - 4	09180-12129	11 - 8	09284-22003	10 - 3		25 - 7		
08319-31087	36 - 23	09140-06013	23 - 6	09180-16044	10 - 10	09284-24001	4 - 18	09404-06431	21 - 3		
08319-31106	23 - 16	09140-28004	11 - 17	09180-18011	4 - 13	09284-34002	11A - 9	09404-06429	5 - 43		
	33 - 3		11A - 15	09181-12167	11A - 20	09285-16002	32 - 5	09407-14403	21 - 4		
08319-31107	30 - 21	09148-04024	27 - 28	09181-25056	4 - 19	09300-08016	2 - 5	09408-00021	21 - 5		
	32 - 7		28 - 8	09181-25057	4 - 19		2 - 22	09408-00066	8 - 16		
08319-31126	22 - 7		29 - 10	09181-25058	4 - 19	09300-14011	12 - 3	09440-07062	33 - 11		
08321-01053	20 - 13		38 - 11	09181-25059	4 - 19	09308M27001	24 - 17	09440-10009	24 - 16		
08321-21064	7 - 10	09148-05004	27 - 30	09181-25060	4 - 19	09319-10002	30 - 20	09440-10019	8 - 8		
08321-01067	13 - 13	09148-05020	27 - 26	09181-25061	4 - 19		36 - 16	09440-10025	8 - 8		
08321-21084	30 - 19		27 - 34	09181-25062	4 - 19	09319-10032	2 - 4	09440-19026	23 - 14		
08321-21107	27 - 15		28 - 11	09181-25063	4 - 19	09319-12051	2 - 2	09440-33003	10 - 14		
08322-01103	23 - 3		29 - 3	09181-25064	4 - 19		2 - 3	09440-52007	11 - 14		
08331-31156	11 - 22		29 - 8	09181-25065	4 - 19	09319-12048	22 - 5		11A - 12		
08331-31226	11 - 30		29 - 14	09181-25066	4 - 19	09320M08049	27 - 19	09443-07001	39 - 3		
	11A - 27	09150-05101	33 - 13	09181-25067	4 - 19	09320M12058	7 - 6	09443-08052	23 - 13		
08331-41246	11A - 6	09159-06017	22 - 3	09181-25068	4 - 19	09321M10002	23 - 7	09443-14026	23 - 20		
08331-41286	11 - 6		39 - 7	09181-25069	4 - 19	09352-30503-600	5 - 40	09443-15047	23 - 4		
08341-31039	14 - 5	09160-05016	20 - 11	09201-05006	11 - 3	09352-20503-600	8 - 10	09448-30016	12 - 2		
09100-06078	23 - 5	09160-05501	18 - 8		11A - 3		8 - 11	09471-12028	17 - 8		
09100-06139	39 - 6	09160-06056	38 - 13	09209-10001	33 - 12		8 - 12	09471-12114	19 - 7		
09100-08223	36 - 21	09160-06502	26 - 12	09250-06001	5 - 41	09352-40703-600	24 - 25		20 - 8		
09100-08260	36 - 22	09160-08064	7 - 5	09262-12018	11A - 5	09352-50823-600	24 - 14	09471-12119	20 - 7		